

2024 HISPANIA CATALOGUE^{50Hz}

HFC/HFO(A2L) 蒸发器

CERTIFICATE 证书



MACHINERY DIRECTIVE, ELECTROMAGNETIC COMPATIBILITY DIRECTIVE ATTESTATION OF CONFORMITY

Technical file of the company mentioned below has been inspected and audit has been completed successfully.
2006/42/EC Machinery Directive has been and 2014/30/EU Electromagnetic Compatibility has been taken as references for these processes.

Company Name : **TAIZHOU HISPANIA REFRIGERATION EQUIPMENT CO., LTD**

Company Address : B-10 Taizhou Economic Zone, Jiangsu, China

Related Directives and Annex : **2006/42/EC Machinery Directive / Annex VIII
2014/30/EU Electromagnetic Compatibility Directive /Annex II**

Related Standards : EN ISO 12100:2010; EN IEC 41000-4-2:2019
EN 41000-4-3:2021; EN 60204-1:2018

Product Name : **AIR UNIT COOLER**

Report No and Date : ZNCT231219001; ZNCT231219004

Product Brand/Model/Type : HEA, HEB, HEC, HED, HEF, HEJ, HER, HEV, HEW, HEP, NEA, NEB, NEC, NED, NEF, NEJ, NER, NEV, NEW, NEP, NEA, AEB, AEC, AED, AEF, AEL, AER, AEW, AEW, AEP, AEA, AEB, AEC, AED, AEF, CEJ, CER, CEV, CEW, CEP, GEA, GEB, GEC, GED, GEF, GEJ, GER, GEV, GEW, GEP

Certificate Number : **M.2024.206.C95837**

Initial Assessment Date : 17.01.2024

Registration Date : 18.01.2024

Reissue Date/No : -

Expiry Date : 17.01.2029

 UDEM International Certification
 Auditing Training Centre Industry
 and Trade Inc. Co.
 Mustafa MEMM+CHLU
 General Manager



The validity of the certificate can be checked through www.udem.com.tr. Upon completion of EC declaration of conformity, it is used solely at the manufacturer's responsibility. The certificate remains the property of UDEM International Certification Auditing Training Centre Industry and Trade Inc. Co. to whom it must be returned upon request. The above named firm must keep a copy of this certificate for 15 years from the registration of certificate. The certificate only covers the products listed above and UDEM must be notified in case of any changes on the products.
Address: Mülkiye Mahallesi 2073 Sokak (Eski 93 Sokak) No:10 Çankaya Ankara - TÜRKİYE
Phone: +90 0312 443 03 90 Fax: +90 0312 443 03 76
E-mail: info@udem.com.tr www.udem.com.tr



MACHINERY DIRECTIVE, ELECTROMAGNETIC COMPATIBILITY DIRECTIVE ATTESTATION OF CONFORMITY

Technical file of the company mentioned below has been inspected and audit has been completed successfully.
2006/42/EC Machinery Directive has been and 2014/30/EU Electromagnetic Compatibility has been taken as references for these processes.

Company Name : **TAIZHOU HISPANIA REFRIGERATION EQUIPMENT CO., LTD**

Company Address : B-10 Taizhou Economic Zone, Jiangsu, China

Related Directives and Annex : **2006/42/EC Machinery Directive / Annex VIII
2014/30/EU Electromagnetic Compatibility Directive /Annex II**

Related Standards : EN ISO 12100:2010; EN IEC 41000-4-2:2019
EN 41000-4-3:2021; EN 60204-1:2018

Product Name : **CONDENSER**

Report No and Date : ZNCT231219003; ZNCT231219006

Product Brand/Model/Type : HCA, HCA5, HCB, HCB5, HCVD, HCH ACA, ACAS, ACB, ACBS, ACV, ACVD, ACH CCV, CCVD, GCH GCA, GCB, GCY, GCVD, GCH

Certificate Number : **M.2024.206.C95837**

Initial Assessment Date : 17.01.2024

Registration Date : 18.01.2024

Reissue Date/No : -

Expiry Date : 17.01.2029

 UDEM International Certification
 Auditing Training Centre Industry
 and Trade Inc. Co.
 Mustafa MEMM+CHLU
 General Manager



The validity of the certificate can be checked through www.udem.com.tr. Upon completion of EC declaration of conformity, it is used solely at the manufacturer's responsibility. The certificate remains the property of UDEM International Certification Auditing Training Centre Industry and Trade Inc. Co. to whom it must be returned upon request. The above named firm must keep a copy of this certificate for 15 years from the registration of certificate. The certificate only covers the products listed above and UDEM must be notified in case of any changes on the products.
Address: Mülkiye Mahallesi 2073 Sokak (Eski 93 Sokak) No:10 Çankaya Ankara - TÜRKİYE
Phone: +90 0312 443 03 90 Fax: +90 0312 443 03 76
E-mail: info@udem.com.tr www.udem.com.tr



MACHINERY DIRECTIVE, ELECTROMAGNETIC COMPATIBILITY DIRECTIVE ATTESTATION OF CONFORMITY

Technical file of the company mentioned below has been inspected and audit has been completed successfully.
2006/42/EC Machinery Directive has been and 2014/30/EU Electromagnetic Compatibility has been taken as references for these processes.

Company Name : **TAIZHOU HISPANIA REFRIGERATION EQUIPMENT CO., LTD**

Company Address : B-10 Taizhou Economic Zone, Jiangsu, China

Related Directives and Annex : **2006/42/EC Machinery Directive / Annex VIII
2014/30/EU Electromagnetic Compatibility Directive /Annex II**

Related Standards : EN ISO 12100:2010; EN IEC 41000-4-2:2019
EN 41000-4-3:2021; EN 60204-1:2018

Product Name : **CONDENSER UNIT**

Report No and Date : ZNCT231219002; ZNCT231219005

Product Brand/Model/Type : HHA, HUB, HUC, HUC PLUS, HUC PLUS T, HHA, HUB, HUC-O, HUA-O, HUR, HUP, HUP-O, HUD, HUW, HUG, HUS CUA, CUB, CUC, CUC PLUS, CUC PLUS T, CUA, CUL, CUC-O, CUA-O, CUR, CUP, CUP-O, CUD, CUW, CUG, CUB AUA, AUB, AUC, AUC PLUS, AUC PLUS T, AUM, AUL, AUC-O, AUA-O, AUR, AUP, AUP-O, AUD, ADW, AUG, AUS

Certificate Number : **M.2024.206.C95838**

Initial Assessment Date : 17.01.2024

Registration Date : 18.01.2024

Reissue Date/No : -

Expiry Date : 17.01.2029

 UDEM International Certification
 Auditing Training Centre Industry
 and Trade Inc. Co.
 Mustafa MEMM+CHLU
 General Manager



The validity of the certificate can be checked through www.udem.com.tr. Upon completion of EC declaration of conformity, it is used solely at the manufacturer's responsibility. The certificate remains the property of UDEM International Certification Auditing Training Centre Industry and Trade Inc. Co. to whom it must be returned upon request. The above named firm must keep a copy of this certificate for 15 years from the registration of certificate. The certificate only covers the products listed above and UDEM must be notified in case of any changes on the products.
Address: Mülkiye Mahallesi 2073 Sokak (Eski 93 Sokak) No:10 Çankaya Ankara - TÜRKİYE
Phone: +90 0312 443 03 90 Fax: +90 0312 443 03 76
E-mail: info@udem.com.tr www.udem.com.tr



CERTIFICATE of conformity of the factory production control No. 2435-PED-8603850

of conformity based on full quality assurance, issued according to point 11 of Annex III of the Directive 2014/52/EU and implemented by Government Decision No. 279/2019 Coll. as amended
Condenser, Condensing unit refer to annex

Technical specification:
Factual file:
Appoint Standard:
Assessment performed:
Model:
Repeat reference:
produced by or for:

Taizhou Hispania Refrigeration Equipment Co.,Ltd
B-10 Taizhou Economic Zone, Jiangsu Province, P.R. China
and produced in the manufacturing plant(s)
B-10 Taizhou Economic Zone, Jiangsu Province, P.R. China
The Annex is an integral part of this certificate.

This certificate attests that all provisions described in relevant parts of the module
Module H - Conformity based on full quality assurance
according module H for the performances set out in the certificate are applied and that
We hereby certify that the aforementioned manufacturer has a quality assurance system in accordance with of the Directive 2014/52/EU

The certificate has been issued on 05 March 2024 and is valid until 04 March 2027 and is based on the evaluation of the report from assessment and technical file of the equipment, where are reported all required data and government of conformity. Report to this certificate is integral part of certificate. The next certification date of issue is 05 March 2026.

Prague, 05 March 2024

 Ing. Lukáš Furtak
 Deputy Director





validity code: **844CA37E-3E3**
Check the validity of this certificate using this code at www.ll-c.info

LL-C (Certification) Czech Republic, a.s. | Poboční 620/3, 186 00 Praha 8

EVAPORATORS FOR HFC/HFO (A2L)

- COMMERCIAL CUBIC EVAPORATORS: AEA	4
- COMPACT-CEILING AIR TYPE EVAPORATORS: AEC & AEC Plus	16
- HIGH EFFICIENCY COMPACT-CEILING AIR TYPE EVAPORATORS: AEJ & AEJ Plus	36
- DUAL DISCHARGE CEILING AIR TYPE EVAPORATORS: AED & AED Plus	44

蒸发器 HFC/HFO(A2L)

- 商用蒸发器: AEA	4
- 紧凑型蒸发器: AEC & AEC Plus	16
- 高效紧凑型蒸发器: AEJ & AEJ Plus	36
- 双出风蒸发器: AED & AED Plus	44



COMMERCIAL CUBIC EVAPORATORS EVAPORADORES CUBICOS COMERCIALES

The AEA range of commercial cubic evaporators has been designed for use in cold rooms for the preservation of fresh and frozen products.

The exchange coils used in the AEA range are highly efficient with special profile aluminum fins and $\varnothing 12$ mm internally grooved copper tubes, with a reduced internal volume to reduce the necessary refrigerant charge, meeting the needs of the different international regulations for the reduction of gases with high greenhouse effect. They are supplied clean and tested under a pressure of 30 bar.

The AEA range has models with 3 different fin pitch depending on the temperature of the cold room:

- AEA XXXX XX 4X: with 4 mm pitch, suitable for high temperatures in the cold room ($Rt \geq 0^{\circ}\text{C}$)
- AEA XXXX XX 6X: with 6 mm pitch, suitable for medium temperatures in the cold room ($Rt \geq -18^{\circ}\text{C}$)
- AEA XXXX XX 9X: with 9 mm pitch, suitable for low temperatures in the cold room ($Rt \geq -35^{\circ}\text{C}$)

The standard electric fans used in this range have the following characteristics:

- $\varnothing 250, 300, 350, 400$ mm: single-phase 230V/1/50 Hz with external rotor, with type K grid and nozzle (short mouth). Operating temperature -40°C to $+40^{\circ}\text{C}$.

AEA SERIES EVAPORATOR 蒸发器系列 AEA

AEA系列商用蒸发器适用于冷库的冷冻冷藏需求。

AEA的高效内芯采用铝箔和 $\varnothing 12$ mm内螺纹铜管，通过减少管容积来降低冷媒充注量，满足全球温室气体的减排需求。所有内芯均经过清洁和30bar保压测试。

AEA有三种片距，满足不同温度的应用：

- AEA XXXX XX 4X: 4mm片距，适用于高温库 ($Rt \geq 0^{\circ}\text{C}$)
- AEA XXXX XX 6X: 6mm片距，适用于中温库 ($Rt \geq -18^{\circ}\text{C}$)
- AEA XXXX XX 9X: 9mm片距，适用于低温库 ($Rt \geq -35^{\circ}\text{C}$)

标准的风机配置如下：

- $\varnothing 250, 300, 350, 400$ mm: 单相230V/1/50Hz外转子电机，带K网罩和短出风口。工作温度 -40°C 至 $+40^{\circ}\text{C}$ 。

AEA SERIES EVAPORATOR

蒸发器系列 AEA

-ø450 mm: three-phase 400V/3/50 Hz with external rotor, with type K grid and nozzle (short mouth). Operating temperature -40°C to +40°C.

-ø500, 550, 630 mm: three-phase 400V/3/50 Hz with external rotor, with L-type grille and nozzle (long mouth). Operating temperature -40°C to +40°C.

-ø630, 800 mm: three-phase 400V/3/50 Hz with external rotor, with ZN-type grille and nozzle (long mouth). Operating temperature -40°C to +40°C.

White powder-coated aluminium casing with high resistance to corrosion and impacts.

In models with electric defrost, stainless steel electric heaters covered by aluminum tubes are used, located in the finned package and in the drip tray to avoid steam problems and make easy replacement.

The electrical parts are connected to an earth terminal, inside a connection box with access holes equipped with cable glands with IP 65 protection.

For performance at work points other than those in this catalog, use the "Unit Selector Hybrid HISPANIA" software.

For special applications and additional information consult our Technical Department.

-ø450 mm: 三相400V/3/50Hz外转子电机, 带K网罩和短出口。工作温度-40°C至+40°C。

-ø500, 550 y 630 mm: 三相400V/3/50Hz外转子电机, 带L网罩和长风口。工作温度-40°C至+40°C。

-ø630 y 800 mm: 三相400V/3/50Hz外转子电机, 带ZN网罩和长风口。工作温度-40°C至+40°C。

白色喷涂的铝制外壳, 有较高的防腐和抗震性能。

电化霜的电加热管套有不锈钢管, 固定于翅片和接水盘内, 可隔绝水蒸气, 且方便维护。

所有电器有效接地。电线均接入防护等级IP65的电器盒内。

可使用"Unit Selector Hybrid HISPANIA"选型软件查询样册以外的工况性能。

更多需求和信息请联系Hispania。

EVAPORATORS / 蒸发器 HFC/HFO(A2L)

AEA 2503 26 4D S1 2 3

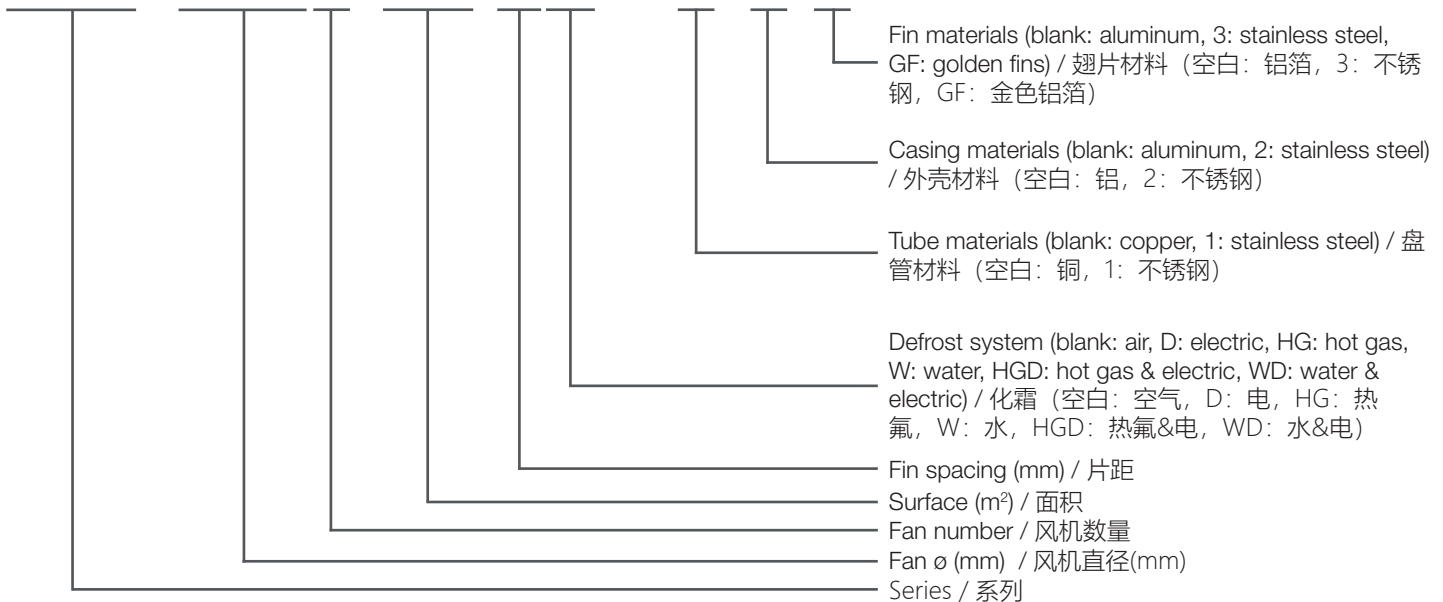

COMMERCIAL CUBIC EVAPORATORS

商用蒸发器

HFC/HFO(A2L)

EVAPORATORS / 蒸发器 HFC/HFO(A2L)

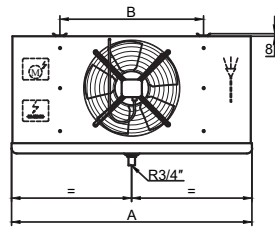
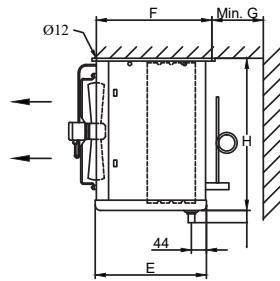

AEA
2501/3001/3501/4001/4501

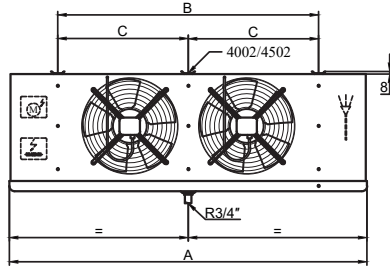

AEA
2502/3002/3502/4002/4502

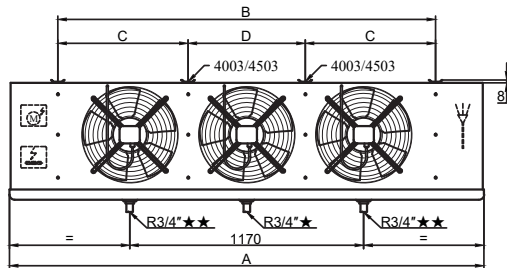

AEA
★2503/3003/3503/4003
★★4503

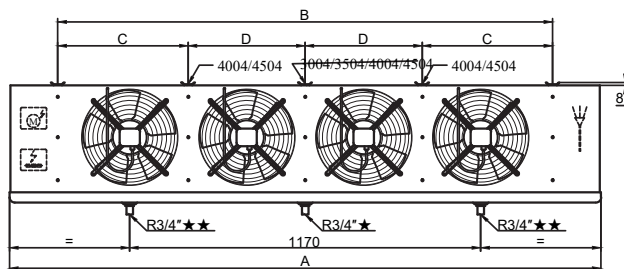

AEA
★2504/3004/3504
★★4004/4504

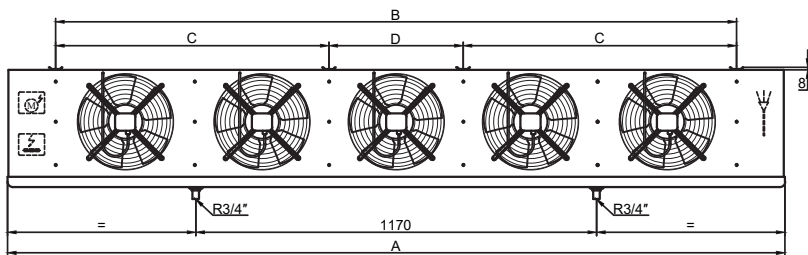

AEA
2505/3005/3505

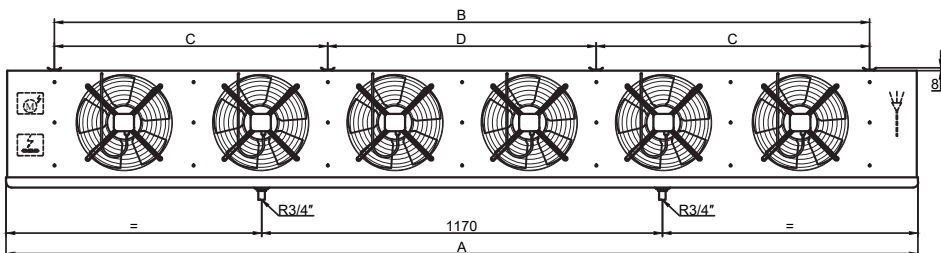

AEA
2506/3006/3506

Model / 型号	Dimensions / 尺寸 (mm)							
	A	B	C	D	E	F	G	H
AEA 2501...	702	420			325	375	200	350
AEA 2502...	1094	812			325	375	200	350
AEA 2503...	1486	1204			325	375	200	350
AEA 2504...	1878	1596	798		325	375	200	350
AEA 2505...	2270	1988	798	392	325	375	200	360
AEA 2506...	2662	2380	798	784	325	375	250	360
AEA 3001...	702	420			325	375	200	460
AEA 3002...	1094	812			325	375	200	460
AEA 3003...	1486	1204			325	375	250	460
AEA 3004...	1878	1596	798		325	375	250	460
AEA 3005...	2270	1988	798	392	325	375	300	470
AEA 3006...	2662	2380	798	784	325	375	300	470
AEA 3501...	702	420			455	507	200	460
AEA 3502...	1094	812			455	507	200	460
AEA 3503...	1486	1204			455	507	250	460
AEA 3504...	1878	1596	798		455	507	250	460
AEA 3505...	2270	1988	798	392	455	507	300	470
AEA 3506...	2662	2380	798	784	455	507	300	470
AEA 4001...	912	630			325	375	250	530
AEA 4002...	1486	1204	602		325	375	300	530
AEA 4003...	1878	1596	546	504	325	375	300	530
AEA 4004...	2662	2380	595	595	325	375	350	540
AEA 4501...	1094	812			325	375	300	600
AEA 4502...	1878	1596	798		325	375	300	600
AEA 4503...	2662	2380	798	784	325	375	350	610
AEA 4504...	3446	3164	798	784	325	375	350	610

COMMERCIAL CUBIC EVAPORATORS

HFC/HFO(A2L)

商用蒸发器

FIN SPACING 4 mm, with electrical defrost. Rt>=0°C

片距4mm, 带电加热。库温>=0°C

Model / 型号	Capacity / 制冷量 R454C (kW)		Capacity / 制冷量 R1234yf (kW)		Surface/ 面积 (m ²)	Tube Volume/ 管容积 (dm ³)	N.W/ 净重 (kg)	Connection/ 接口尺寸 (ø mm)	
	t _e = -8°C	t _e = -25°C	t _e = -8°C	t _e = -25°C				Inlet/ 进口	Outlet/ 出口
	DT1=8K	DT1=7K	DT1=8K	DT1=7K					
AEA 2501 09 4D	1.61	1.16	1.40	0.94	8.3	1.4	12	12	16
AEA 2502 17 4D	3.27	2.39	2.89	1.96	16.7	2.8	21	12	19
AEA 2503 26 4D	4.92	3.61	4.38	2.99	25.1	4.2	30	12	22
AEA 2504 35 4D	6.38	4.75	5.62	4.01	33.5	5.6	38	12	22
AEA 2505 41 4D	8.22	6.04	7.41	5.12	41.8	7.0	47	15	28
AEA 2506 52 4D	9.90	7.29	8.84	6.07	50.2	8.5	56	15	28
AEA 3001 12 4D	2.43	1.79	2.11	1.49	11.1	1.9	15	12	19
AEA 3002 23 4D	4.90	3.63	4.29	3.03	22.3	3.8	25	12	22
AEA 3003 35 4D	7.37	5.47	6.48	4.58	33.5	5.6	36	12	22
AEA 3004 46 4D	10.00	7.35	8.88	6.18	44.6	7.5	47	15	28
AEA 3005 56 4D	12.49	9.25	11.16	7.80	55.8	9.4	58	15	28
AEA 3006 69 4D	15.02	10.99	13.10	9.14	67.0	11.3	68	15	28
AEA 3501 14 4D	3.33	2.55	2.82	2.04	13.9	2.3	18	12	19
AEA 3502 27 4D	6.71	5.16	5.72	4.15	27.9	4.7	33	12	22
AEA 3503 41 4D	10.51	7.92	9.24	6.50	41.8	7.0	47	15	22
AEA 3504 55 4D	13.85	10.64	12.33	8.71	55.8	9.4	62	15	28
AEA 3505 70 4D	17.58	13.29	15.52	10.96	69.7	11.7	76	15	35
AEA 3506 83 4D	21.06	15.44	18.04	12.69	83.7	14.1	91	15	35
AEA 4001 20 4D	5.15	3.92	4.47	3.19	19.9	3.4	24	12	19
AEA 4002 40 4D	10.30	7.89	9.12	6.49	39.0	6.6	42	12	22
AEA 4003 54 4D	14.43	10.68	12.36	8.87	52.1	8.8	57	15	28
AEA 4004 81 4D	20.68	15.86	18.37	13.11	78.1	13.2	80	15	35
AEA 4501 31 4D	8.27	6.10	7.16	5.11	29.7	5.0	31	12	22
AEA 4502 61 4D	16.65	12.31	14.62	10.51	59.5	10.0	57	15	28
AEA 4503 92 4D	23.52	17.11	22.51	16.28	89.3	15.0	82	15	35
AEA 4504 119 4D	33.42	24.73	29.55	21.32	119.1	20.0	107	22	42

EVAPORATORS / 蒸发器 HFC/HFO(A2L)

FIN SPACING 4 mm, with electrical defrost. Rt>=0°C

片距4mm, 带电加热。库温>=0°C

Model/ 型号	Axial Fans/ 轴流风机							Electric Defrost/ 电化霜		
	Diameter 直径 (Φ mm)	N°	Voltage/ 电压 (V, 50Hz)	Power/ 功率 (W)	Current/ 电流 (A)	Air Flow/ 风量 (m3/h)	Air Throw/ 射程 (m)	Coil/ 内芯 (W)	Drain Pan/ 接水盘 (W)	Total/ 总 功率 (W)
AEA 2501 09 4D	250	1	1 ~ 230	50	0.2	777	4	2 × 250	1 × 250	750
AEA 2502 17 4D	250	2	1 ~ 230	100	0.5	1554	5	2 × 420	1 × 420	1260
AEA 2503 26 4D	250	3	1 ~ 230	150	0.7	2332	6	2 × 580	1 × 580	1740
AEA 2504 35 4D	250	4	1 ~ 230	200	0.9	3112	7	2 × 745	1 × 745	2235
AEA 2505 41 4D	250	5	1 ~ 230	250	1.2	3889	8	2 × 860	1 × 860	2580
AEA 2506 52 4D	250	6	1 ~ 230	300	1.4	4666	10	2 × 1040	1 × 1040	3120
AEA 3001 12 4D	300	1	1 ~ 230	72	0.3	1288	6	3 × 250	1 × 250	1000
AEA 3002 23 4D	300	2	1 ~ 230	144	0.6	2577	7	3 × 420	1 × 420	1680
AEA 3003 35 4D	300	3	1 ~ 230	216	1.0	3867	9	3 × 580	1 × 580	4120
AEA 3004 46 4D	300	4	1 ~ 230	288	1.3	5155	10	3 × 745	1 × 745	2980
AEA 3005 56 4D	300	5	1 ~ 230	360	1.6	6444	13	3 × 860	1 × 860	3250
AEA 3006 69 4D	300	6	1 ~ 230	432	1.9	7732	15	3 × 1040	1 × 1040	4160
AEA 3501 14 4D	350	1	1 ~ 230	130	0.6	1759	10	4 × 250	2 × 250	1500
AEA 3502 27 4D	350	2	1 ~ 230	260	1.2	3524	13	4 × 420	2 × 420	2520
AEA 3503 41 4D	350	3	1 ~ 230	390	1.7	5282	16	4 × 580	2 × 580	6180
AEA 3504 55 4D	350	4	1 ~ 230	520	2.3	7050	19	4 × 745	2 × 745	4470
AEA 3505 70 4D	350	5	1 ~ 230	650	2.9	8808	21	4 × 860	2 × 860	5160
AEA 3506 83 4D	350	6	1 ~ 230	780	3.5	10566	23	4 × 1040	2 × 1040	6240
AEA 4001 20 4D	400	1	1 ~ 230	160	0.7	3139	11	4 × 330	1 × 330	1650
AEA 4002 40 4D	400	2	1 ~ 230	320	1.5	6217	13	4 × 580	1 × 580	5150
AEA 4003 54 4D	400	3	1 ~ 230	480	2.2	8824	16	4 × 745	1 × 745	3725
AEA 4004 81 4D	400	4	1 ~ 230	640	2.9	12439	19	4 × 1040	1 × 1040	5200
AEA 4501 31 4D	450	1	3 ~ 400	460	1.0	5458	15	4 × 420	1 × 420	2100
AEA 4502 61 4D	450	2	3 ~ 400	920	1.9	10920	18	4 × 745	1 × 745	3725
AEA 4503 92 4D	450	3	3 ~ 400	1380	2.9	16391	21	4 × 1040	1 × 1040	5200
AEA 4504 119 4D	450	4	3 ~ 400	1840	3.8	21845	23	4 × 1380	1 × 1380	6900

COMMERCIAL CUBIC EVAPORATORS

HFC/HFO(A2L)

商用蒸发器

FIN SPACING 6 mm, with electrical defrost. Rt>=-18°C

片距6mm, 带电化霜库温>=-18°C

Model / 型号	Capacity / 制冷量 R454C (kW)		Capacity / 制冷量 R1234yf (kW)		Surface/ 面积 (m ²)	Tube Volume/ 管容积 (dm ³)	N.W/ 净重 (kg)	Connection/ 接口尺寸 (ø mm)	
	t _e = -8°C	t _e = -25°C	t _e = -8°C	t _e = -25°C				Inlet/ 进口	Outlet/ 出口
	DT1=8K	DT1=7K	DT1=8K	DT1=7K					
AEA 2501 06 6D	1.38	0.99	1.22	0.82	5.7	1.4	12	12	16
AEA 2502 11 6D	2.80	2.03	2.51	1.71	11.5	2.8	20	12	19
AEA 2503 17 6D	4.22	3.07	3.81	2.59	17.3	4.2	29	12	22
AEA 2504 23 6D	5.28	3.95	4.63	3.34	23.0	5.6	37	12	22
AEA 2505 29 6D	7.00	5.08	6.24	4.35	28.8	7.0	45	15	28
AEA 2506 35 6D	8.48	6.19	7.68	5.24	34.5	8.5	54	15	28
AEA 3001 08 6D	2.00	1.49	1.73	1.24	7.6	1.9	14	12	19
AEA 3002 15 6D	4.03	3.00	3.51	2.51	15.3	3.8	25	12	22
AEA 3003 23 6D	6.06	4.51	5.29	3.79	23.0	5.6	35	12	22
AEA 3004 31 6D	8.47	6.20	7.62	5.25	30.7	7.5	45	15	28
AEA 3005 38 6D	10.55	7.74	9.49	6.58	38.4	9.4	55	15	28
AEA 3006 46 6D	12.78	9.37	11.42	7.87	46.1	11.3	66	15	28
AEA 3501 10 6D	2.81	2.18	2.36	1.73	9.6	2.3	18	12	19
AEA 3502 19 6D	5.66	4.39	4.78	3.51	19.2	4.7	32	12	22
AEA 3503 28 6D	9.22	6.94	8.19	5.72	28.8	7.0	46	15	22
AEA 3504 38 6D	12.09	9.14	10.53	7.49	38.4	9.4	60	15	28
AEA 3505 48 6D	15.42	11.62	13.75	9.64	48.0	11.7	74	15	35
AEA 3506 57 6D	18.60	13.77	16.22	11.37	57.6	14.1	88	15	35
AEA 4001 13 6D	4.24	3.20	3.61	2.61	13.7	3.4	23	12	19
AEA 4002 27 6D	8.66	6.47	7.55	5.36	26.8	6.6	41	12	22
AEA 4003 36 6D	12.29	9.14	10.82	7.62	35.8	8.8	55	15	28
AEA 4004 54 6D	17.37	12.99	15.21	10.80	53.7	13.2	78	15	35
AEA 4501 20 6D	6.93	4.98	6.26	4.39	20.4	5.0	30	12	22
AEA 4502 41 6D	13.93	10.02	12.63	8.99	40.9	10.0	54	15	28
AEA 4503 61 6D	18.70	13.73	18.87	13.35	61.4	15.0	79	15	35
AEA 4504 82 6D	27.93	20.11	25.46	18.19	81.9	20.0	103	22	42

EVAPORATORS / 蒸发器 HFC/HFO(A2L)

FIN SPACING 6 mm, with electrical defrost. Rt>=-18°C

片距6mm, 带电化霜库温>=-18°C

Model/ 型号	Axial Fans/ 轴流风机							Electric Defrost/ 电化霜		
	Diameter 直径 (Φ mm)	N°	Voltage/ 电压 (V, 50Hz)	Power/ 功率 (W)	Current/ 电流 (A)	Air Flow/ 风量 (m3/h)	Air Throw/ 射程 (m)	Coil/ 内芯 (W)	Drain Pan/ 接水盘 (W)	Total/ 总 功率 (W)
AEA 2501 06 6D	250	1	1 ~ 230	50	0.2	822	4	2 × 250	1 × 250	750
AEA 2502 11 6D	250	2	1 ~ 230	100	0.5	1646	5	2 × 420	1 × 420	1260
AEA 2503 17 6D	250	3	1 ~ 230	150	0.7	2469	6	2 × 580	1 × 580	1740
AEA 2504 23 6D	250	4	1 ~ 230	200	0.9	3295	7	2 × 745	1 × 745	2235
AEA 2505 29 6D	250	5	1 ~ 230	250	1.2	4117	8	2 × 860	1 × 860	2580
AEA 2506 35 6D	250	6	1 ~ 230	300	1.4	4940	10	2 × 1040	1 × 1040	3120
AEA 3001 08 6D	300	1	1 ~ 230	72	0.3	1350	6	3 × 250	1 × 250	1000
AEA 3002 15 6D	300	2	1 ~ 230	144	0.6	2702	7	3 × 420	1 × 420	1680
AEA 3003 23 6D	300	3	1 ~ 230	216	1.0	4054	9	3 × 580	1 × 580	4120
AEA 3004 31 6D	300	4	1 ~ 230	288	1.3	5404	11	3 × 745	1 × 745	2980
AEA 3005 38 6D	300	5	1 ~ 230	360	1.6	6756	13	3 × 860	1 × 860	3250
AEA 3006 46 6D	300	6	1 ~ 230	432	1.9	8105	15	3 × 1040	1 × 1040	4160
AEA 3501 10 6D	350	1	1 ~ 230	130	0.6	1920	10	4 × 250	2 × 250	1500
AEA 3502 19 6D	350	2	1 ~ 230	260	1.2	3846	14	4 × 420	2 × 420	2520
AEA 3503 28 6D	350	3	1 ~ 230	390	1.7	5762	16	4 × 580	2 × 580	6180
AEA 3504 38 6D	350	4	1 ~ 230	520	2.3	7691	20	4 × 745	2 × 745	4470
AEA 3505 48 6D	350	5	1 ~ 230	650	2.9	9608	22	4 × 860	2 × 860	5160
AEA 3506 57 6D	350	6	1 ~ 230	780	3.5	11525	24	4 × 1040	2 × 1040	6240
AEA 4001 13 6D	400	1	1 ~ 230	160	0.7	3294	11	4 × 330	1 × 330	1650
AEA 4002 27 6D	400	2	1 ~ 230	320	1.5	6536	14	4 × 580	1 × 580	5150
AEA 4003 36 6D	400	3	1 ~ 230	480	2.2	9370	16	4 × 745	1 × 745	3725
AEA 4004 54 6D	400	4	1 ~ 230	640	2.9	13074	19	4 × 1040	1 × 1040	5200
AEA 4501 20 6D	450	1	3 ~ 400	460	1.0	5686	15	4 × 420	1 × 420	2100
AEA 4502 41 6D	450	2	3 ~ 400	920	1.9	11375	18	4 × 745	1 × 745	3725
AEA 4503 61 6D	450	3	3 ~ 400	1380	2.9	17074	22	4 × 1040	1 × 1040	5200
AEA 4504 82 6D	450	4	3 ~ 400	1840	3.8	22753	24	4 × 1380	1 × 1380	6900

COMMERCIAL CUBIC EVAPORATORS

HFC/HFO(A2L)

商用蒸发器

FIN SPACING 9 mm, with electrical defrost. Rt>=-35°C

片距9mm, 带电加热。库温>=-35°C

Model / 型号	Capacity / 制冷量 R454C (kW)		Capacity / 制冷量 R1234yf (kW)		Surface/ 面积 (m ²)	Tube Volume/ 管容积 (dm ³)	N.W/ 净重 (kg)	Connection/ 接口尺寸 (ø mm)	
	t _e = -8°C	t _e = -25°C	t _e = -8°C	t _e = -25°C				Inlet/ 进口	Outlet/ 出口
	DT1=8K	DT1=7K	DT1=8K	DT1=7K					
AEA 2501 04 9D	1.15	0.82	1.01	0.69	4.0	1.4	11	12	16
AEA 2502 08 9D	2.32	1.65	2.07	1.42	8.0	2.8	19	12	19
AEA 2503 12 9D	3.49	2.50	3.13	2.15	12.0	4.2	27	12	22
AEA 2504 16 9D	4.21	3.17	3.69	2.69	16.1	5.6	36	12	22
AEA 2505 20 9D	5.62	4.11	5.02	3.55	20.1	7.0	44	15	28
AEA 2506 24 9D	7.01	5.02	6.30	4.34	24.1	8.5	51	15	28
AEA 3001 06 9D	1.58	1.19	1.37	0.99	5.3	1.9	14	12	19
AEA 3002 10 9D	3.19	2.39	2.77	2.01	10.7	3.8	24	12	22
AEA 3003 16 9D	4.79	3.59	4.17	3.03	16.0	5.6	33	12	22
AEA 3004 21 9D	6.92	4.99	6.17	4.29	21.4	7.5	43	15	28
AEA 3005 27 9D	8.53	6.21	7.59	5.34	26.8	9.4	53	15	28
AEA 3006 31 9D	10.48	7.56	9.49	6.50	32.1	11.3	63	15	28
AEA 3501 07 9D	2.29	1.78	1.91	1.42	6.7	2.3	17	12	19
AEA 3502 13 9D	4.60	3.58	3.86	2.88	13.4	4.7	31	12	22
AEA 3503 20 9D	7.79	5.77	6.96	4.84	20.1	7.0	44	15	22
AEA 3504 27 9D	9.92	7.48	8.60	6.20	26.8	9.4	57	15	28
AEA 3505 34 9D	13.03	9.65	11.67	8.12	33.5	11.7	70	15	35
AEA 3506 40 9D	15.81	11.67	14.13	9.77	40.2	14.1	84	15	35
AEA 4001 09 9D	3.32	2.52	2.82	2.07	9.6	3.4	22	12	19
AEA 4002 18 9D	6.85	5.12	5.93	4.26	18.7	6.6	39	12	22
AEA 4003 24 9D	10.07	7.43	9.04	6.27	25.0	8.8	53	15	28
AEA 4004 36 9D	13.73	10.27	11.91	8.60	37.5	13.2	74	15	35
AEA 4501 14 9D	5.50	3.93	5.22	3.61	14.3	5.0	28	12	22
AEA 4502 28 9D	11.05	7.89	10.57	7.36	28.5	10.0	51	15	28
AEA 4503 41 9D	14.44	10.71	14.71	10.58	42.8	15.0	74	15	35
AEA 4504 57 9D	22.14	15.82	21.27	14.85	57.1	20.0	97	22	42

FIN SPACING 9 mm, with electrical defrost. Rt>=-35°C

片距9mm, 带电加热。库温>=-35°C

Model/ 型号	Axial Fans/ 轴流风机							Electric Defrost/ 电化霜		
	Diameter 直径 (Φ mm)	N°	Voltage/ 电压 (V, 50Hz)	Power/ 功率 (W)	Current/ 电流 (A)	Air Flow/ 风量 (m3/h)	Air Throw/ 射程 (m)	Coil/ 内芯 (W)	Drain Pan/ 接水盘 (W)	Total/ 总 功率 (W)
AEA 2501 04 9D	250	1	1 ~ 230	50	0.2	866	4	2 × 250	1 × 250	750
AEA 2502 08 9D	250	2	1 ~ 230	100	0.5	1733	5	2 × 420	1 × 420	1260
AEA 2503 12 9D	250	3	1 ~ 230	150	0.7	2599	6	2 × 580	1 × 580	1740
AEA 2504 16 9D	250	4	1 ~ 230	200	0.9	3469	7	2 × 745	1 × 745	2235
AEA 2505 20 9D	250	5	1 ~ 230	250	1.2	4334	9	2 × 860	1 × 860	2580
AEA 2506 24 9D	250	6	1 ~ 230	300	1.4	5200	10	2 × 1040	1 × 1040	3120
AEA 3001 06 9D	300	1	1 ~ 230	72	0.3	1412	6	3 × 250	1 × 250	1000
AEA 3002 10 9D	300	2	1 ~ 230	144	0.6	2826	7	3 × 420	1 × 420	1680
AEA 3003 16 9D	300	3	1 ~ 230	216	1.0	4240	9	3 × 580	1 × 580	4120
AEA 3004 21 9D	300	4	1 ~ 230	288	1.3	5651	11	3 × 745	1 × 745	2980
AEA 3005 27 9D	300	5	1 ~ 230	360	1.6	7065	13	3 × 860	1 × 860	3250
AEA 3006 31 9D	300	6	1 ~ 230	432	1.9	8475	15	3 × 1040	1 × 1040	4160
AEA 3501 07 9D	350	1	1 ~ 230	130	0.6	2084	11	4 × 250	2 × 250	1500
AEA 3502 13 9D	350	2	1 ~ 230	260	1.2	4174	14	4 × 420	2 × 420	2520
AEA 3503 20 9D	350	3	1 ~ 230	390	1.7	6252	17	4 × 580	2 × 580	6180
AEA 3504 27 9D	350	4	1 ~ 230	520	2.3	8346	20	4 × 745	2 × 745	4470
AEA 3505 34 9D	350	5	1 ~ 230	650	2.9	10424	22	4 × 860	2 × 860	5160
AEA 3506 40 9D	350	6	1 ~ 230	780	3.5	12503	24	4 × 1040	2 × 1040	6240
AEA 4001 09 9D	400	1	1 ~ 230	160	0.7	3438	11	4 × 330	1 × 330	1650
AEA 4002 18 9D	400	2	1 ~ 230	320	1.5	6826	14	4 × 580	1 × 580	5150
AEA 4003 24 9D	400	3	1 ~ 230	480	2.2	9837	16	4 × 745	1 × 745	3725
AEA 4004 36 9D	400	4	1 ~ 230	640	2.9	13655	20	4 × 1040	1 × 1040	5200
AEA 4501 14 9D	450	1	3 ~ 400	460	1.0	5900	15	4 × 420	1 × 420	2100
AEA 4502 28 9D	450	2	3 ~ 400	920	1.9	11803	18	4 × 745	1 × 745	3725
AEA 4503 41 9D	450	3	3 ~ 400	1380	2.9	17716	22	4 × 1040	1 × 1040	5200
AEA 4504 57 9D	450	4	3 ~ 400	1840	3.8	23609	24	4 × 1380	1 × 1380	6900

AVAILABLE OPTIONS FOR AEA SERIES:

Defrost options:

- Without defrost (air)
- D: Electrical defrost: standard model
- HG: hot gas
- W: water
- HGD: hot gas defrost for coil and electrical defrost for tray
- WD: water and electrical

Tube material options:

- Copper: standard models
- 1: Stainless steel AISI SUS304

Coil protection options:

- Aluminium fins: standard models
- Fins with GOLDFIN anti-corrosion high resistance coating.

Fan options:

- EC Fans
- Silica gel AEAters for fan nozzles: only for ø500 mm or above models
- Streamers: Air-guiding device for increased airthrow

Casing options:

- White powder-coated painted aluminium: standard models
- 2: stainless steel AISI SUS304

Other options:

- Double insulated drip tray (recommended for low temperature room applications)
- Thermal protector for defrosting electrical AEAters

AEA 系列选配件

化霜:

- 无化霜 (空气)
- D: 电化霜: 标准型号
- HG: 热氟
- W: 水
- HGD: 内芯热氟化霜, 接水盘电化霜
- WD: 水和电化霜

盘管材质:

- 铜管: 标准型号
- 1: 304不锈钢

内芯材质:

- 铝箔: 标准型号
- 高防腐性的金色铝箔

风机:

- EC风机
- 风筒电加热: 仅供500mm及以上的风机
- 导风筒: 增加射程

外壳:

- 铝制白色喷涂: 标准型号
- 2: 304不锈钢

其他:

- 双接水盘 (低温工况推荐)
- 电化霜热保护器



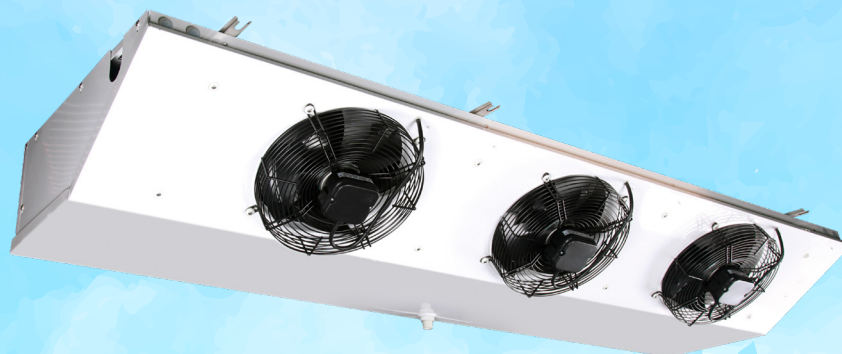

COMPACT-CEILING AIR TYPE EVAPORATORS 紧凑型蒸发器

The AEC range of compact-ceiling air type evaporators has been designed for use in low height commercial cold rooms for the preservation of fresh and frozen products.

The exchange coils used in the AEC range are built with geometries of recognized high efficiency, with special profile aluminum fins and $\varnothing 12$ mm internally grooved (AEC 25XX, AEC Plus 30XX) or $\varnothing 15$ mm (AEC 30XX) high quality copper tubes, with high heat transfer coefficient. They are supplied clean and tested under a pressure of 30 bar.

The AEC range has models with different fin pitch depending on the temperature of the cold room:

For high temperatures in the cold room

- AEC 25XX XX 4X: with 4 mm pitch ($Rt \geq 0^{\circ}\text{C}$)
- AEC Plus 30XX XX 4X: with 4 mm pitch ($Rt \geq 0^{\circ}\text{C}$)
- AEC 30XX XX 4.5X: with 4.5 mm pitch ($Rt \geq 0^{\circ}\text{C}$)

For medium temperatures in the cold room

- AEC 25XX XX 6X: with 6 mm pitch ($Rt \geq -18^{\circ}\text{C}$)
- AEC Plus 30XX XX 6X: with 6 mm pitch ($Rt \geq -18^{\circ}\text{C}$)
- AEC 30XX XX 7X: with 7 mm pitch ($Rt \geq -20^{\circ}\text{C}$)

For low temperatures in the cold room

- AEC 25XX XX 9X: with 9 mm pitch ($Rt \geq -35^{\circ}\text{C}$)
- AEC Plus 30XX XX 9X: with 9 mm pitch ($Rt \geq -35^{\circ}\text{C}$)
- AEC 30XX XX 10X: with 10 mm pitch ($Rt \geq -35^{\circ}\text{C}$)

AEC SERIES EVAPORATOR 蒸发器系列 AEC

AEC系列紧凑型蒸发器适用于空间高度较小的冷库的冷冻冷藏需求。

AEC的高效内芯采用铝箔和 $\varnothing 12$ mm内螺纹铜管(AEC 25XX, AEC Plus 30XX)或者 $\varnothing 15$ mm光管(AEC 30XX), 具有较高的换热性能。所有内芯均经过清洁和30bar保压测试。

AEC有多种片距, 满足不同温度的应用:

高温库

- AEC 25XX XX 4X: 4mm片距 ($Rt \geq 0^{\circ}\text{C}$)
- AEC Plus 30XX XX 4X: 4mm片距 ($Rt \geq 0^{\circ}\text{C}$)
- AEC 30XX XX 4.5X: 4.5mm片距 ($Rt \geq 0^{\circ}\text{C}$)

中温库

- AEC 25XX XX 6X: 6mm片距 ($Rt \geq -18^{\circ}\text{C}$)
- AEC Plus 30XX XX 6X: 6mm片距 ($Rt \geq -18^{\circ}\text{C}$)
- AEC 30XX XX 7X: 7mm片距 ($Rt \geq -20^{\circ}\text{C}$)

低温库

- AEC 25XX XX 9X: 9mm片距 ($Rt \geq -35^{\circ}\text{C}$)
- AEC Plus 30XX XX 9X: 9mm片距 ($Rt \geq -35^{\circ}\text{C}$)
- AEC 30XX XX 10X: 10mm片距 ($Rt \geq -35^{\circ}\text{C}$)

AEC & AEC Plus SERIES EVAPORATOR

蒸发器系列 AEC & AEC Plus

The standard electric fans used in this range have the following characteristics:

-Single-phase 230V/1/50 Hz with external rotor, with type K grid and nozzle (short mouth). Operating temperature -40°C to +40°C.

White powder-coated aluminium casing with high resistance to corrosion and impacts.

In models with electric defrost, stainless steel electric heaters covered by aluminum tubes are used, located in the finned package and in the drip tray to avoid steam problems and make easy replacement.

The electrical parts are connected to an earth terminal, inside a connection box with access holes equipped with cable glands with IP 65 protection.

For performance at work points other than those in this catalog, use the "Unit Selector Hybrid HISPANIA" software.

For special applications and additional information consult our Technical Department.

标准的风机配置如下：

-单相230V/1/50Hz外转子电机，带K网罩和短出风口。工作温度-40°C至+40°C。

白色喷涂的铝制外壳，有较高的防腐蚀和抗震性能。

电化霜的电加热管套有不锈钢管，固定于翅片和接水盘内，可隔绝水蒸气，且方便维护。

所有电器有效接地。电线均接入防护等级IP65的电器盒内。

可使用"Unit Selector Hybrid HISPANIA"选型软件查询样册以外的工况性能。

更多需求和信息请联系Hispania。

EVAPORATORS / 蒸发器 HFC/HFO(A2L)

AEC 2503 26 4D S1 2 3

Fin materials (blank: aluminum, 3: stainless steel, GF: golden fins) / 翅片材料 (空白: 铝箔, 3: 不锈钢, GF: 金色铝箔)

Casing materials (blank: aluminum, 2: stainless steel) / 外壳材料 (空白: 铝, 2: 不锈钢)

Tube materials (blank: copper, 1: stainless steel) / 盘管材料 (空白: 铜, 1: 不锈钢)

Defrost system (blank: air, D: electric, HG: hot gas, W: water, HGD: hot gas & electric, WD: water & electric) / 化霜 (空白: 空气, D: 电, HG: 热氟, W: 水, HGD: 热氟&电, WD: 水&电)

Fin spacing (mm) / 片距

Surface (m²) / 面积

Fan number / 风机数量

Fan ø (mm) / 风机直径(mm)

Series / 系列

COMPACT-CEILING AIR TYPE EVAPORATORS

紧凑型蒸发器

HFC/HFO(A2L)

EVAPORATORS / 蒸发器 HFC/HFO(A2L)

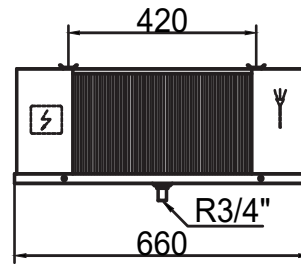
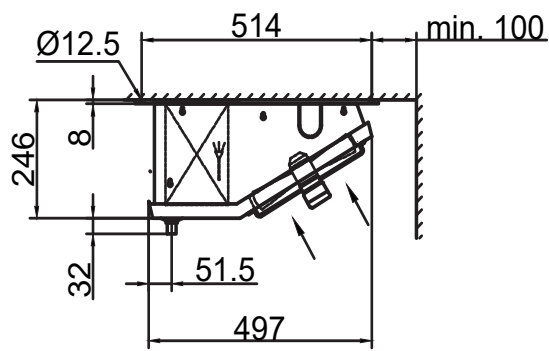

AEC/D 2501

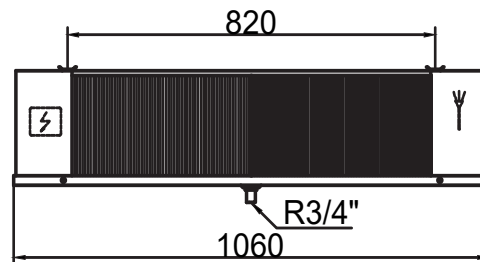

AEC/D 2502

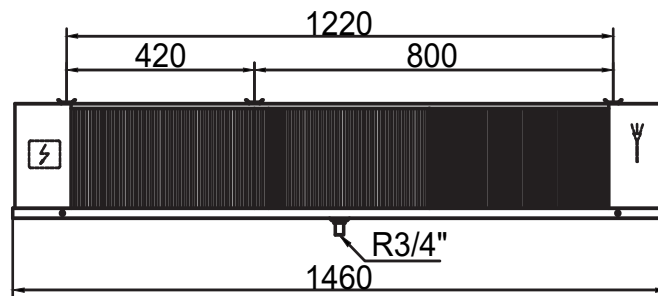

AEC/D 2503

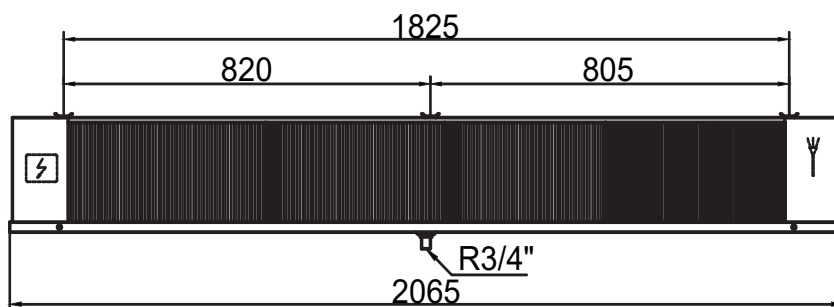

AEC/D 2504

Dia. 1

AEC & AEC Plus SERIES EVAPORATOR

蒸发器系列 AEC & AEC Plus

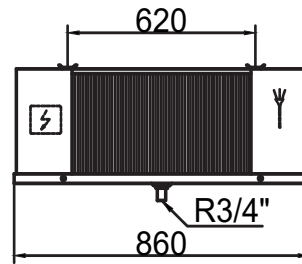
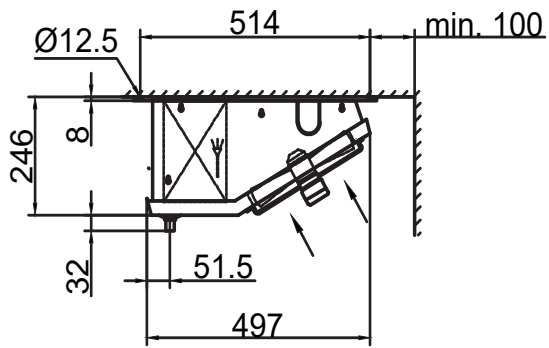

AEC/D 2501

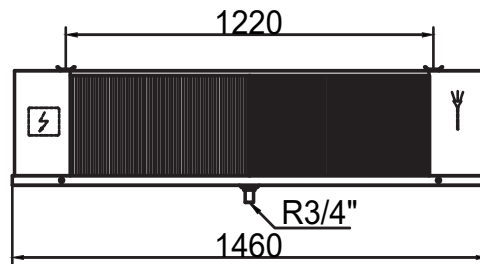

AEC/D 2502

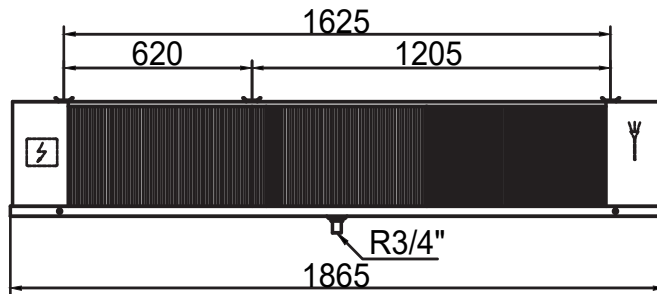

AEC/D 2503

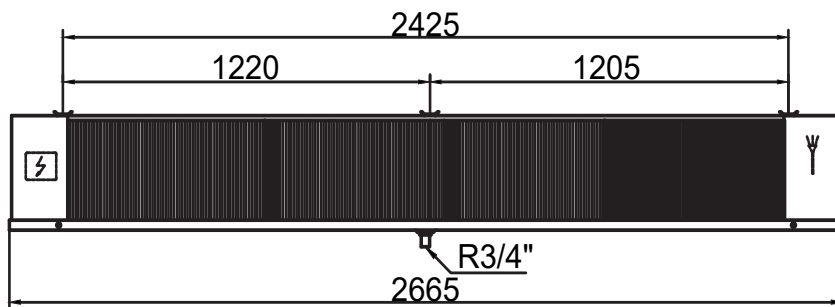

AEC/D 2504

Dia. 2

COMPACT-CEILING AIR TYPE EVAPORATORS

紧凑型蒸发器

HFC/HFO(A2L)

EVAPORATORS / 蒸发器 HFC/HFO(A2L)

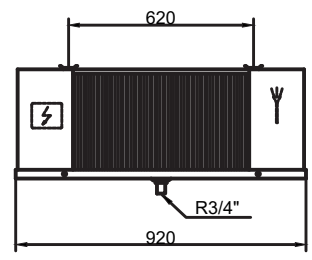
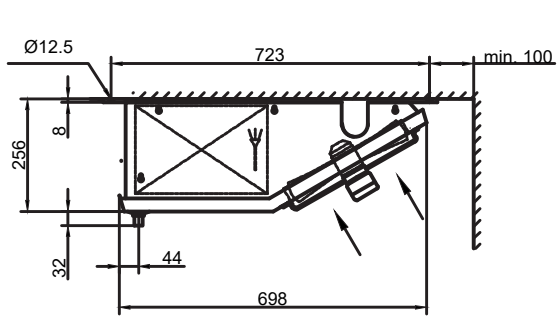

AEC/D 3001

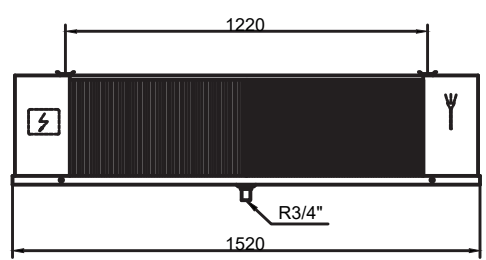

AEC/D 3002

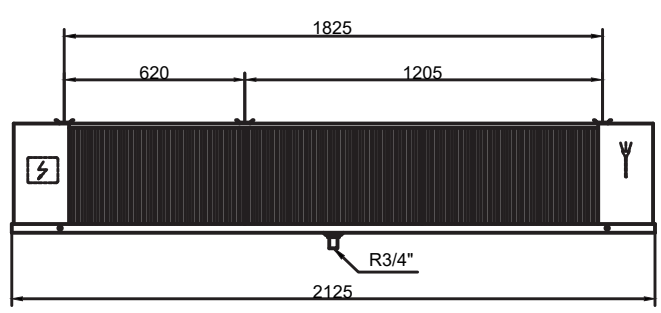

AEC/D 3003

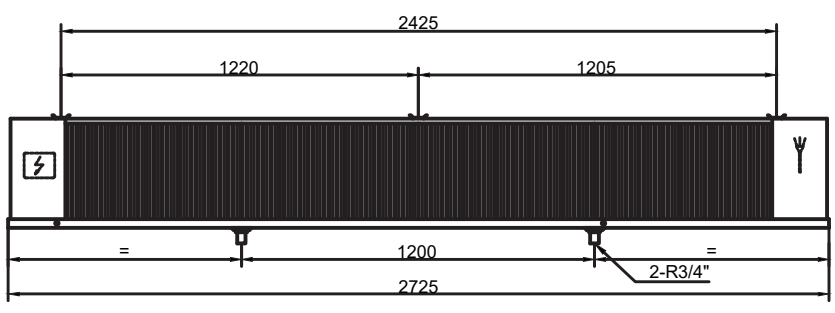

AEC/D 3004

AEC & AEC Plus SERIES EVAPORATOR

蒸发器系列 AEC & AEC Plus

EVAPORATORS / 蒸发器 HFC/HFO(A2L)

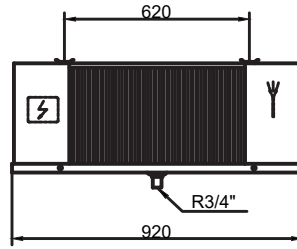
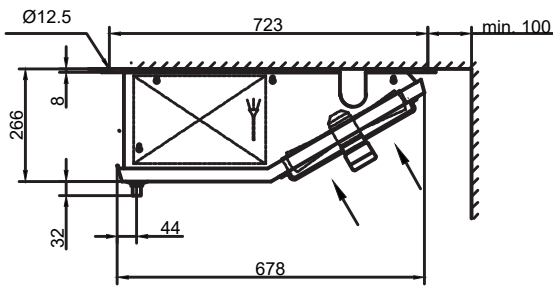

AEC/D PLUS 3001

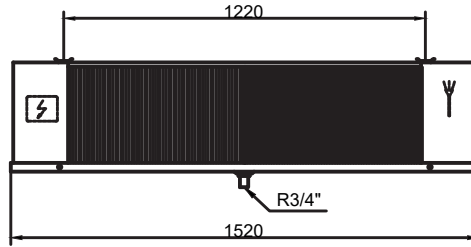

AEC/D PLUS 3002

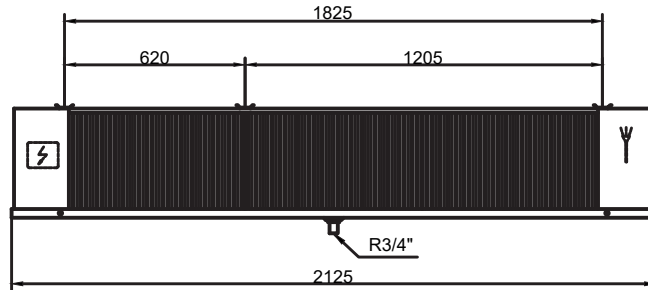

AEC/D PLUS 3003

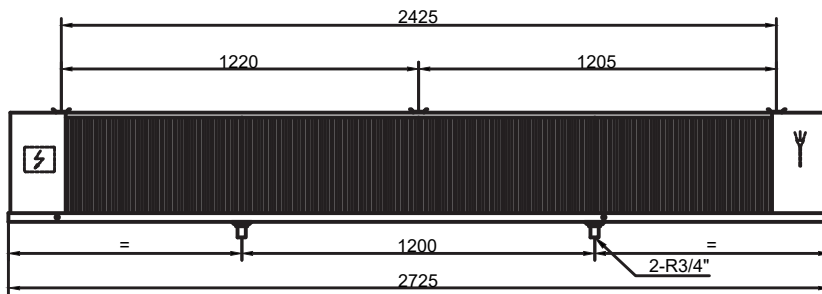

AEC/D PLUS 3004

FIN SPACING 4 mm, with electrical defrost. Rt>=0°C

片距4mm, 带电加热。库温>=0°C

Model / 型号	Capacity / 制冷量 R454C (kW)		Capacity / 制冷量 R1234yf (kW)		Surface/ 面积 (m ²)	Tube Volume/ 管容积 (dm ³)	N.W/ 净重 (kg)	Connection/ 接口尺寸 (ø mm)		Dimen- sion 尺寸 (mm)
	t _e = 0°C	t _e = -8°C	t _e = 0°C	t _e = -8°C				Inlet/ 进口	Out- let/ 出口	
	DT1=10K	DT1=8K	DT1=10K	DT1=8K						
AEC 2501 05 4D	1.69	1.16	1.39	0.94	4.3	0.7	11	12	12	Dia. 1
AEC 2501 06 4D	1.74	1.18	1.58	1.07	5.7	1.0	12	12	12	Dia. 1
AEC 2501 07 4D	2.05	1.39	1.81	1.23	6.4	1.1	13	12	12	Dia. 2
AEC 2501 09 4D	2.73	1.91	1.98	1.33	8.5	1.4	16	12	12	Dia. 2
AEC 2502 12 4D	3.50	2.38	3.23	2.19	11.4	1.9	18	12	19	Dia. 1
AEC 2502 18 4D	4.87	3.36	4.09	2.77	17.1	2.9	23	12	19	Dia. 2
AEC 2503 17 4D	5.26	3.57	4.89	3.31	17.1	2.9	32	12	22	Dia. 1
AEC 2503 26 4D	7.32	4.98	6.73	4.57	25.7	4.3	42	12	28	Dia. 2
AEC 2504 23 4D	7.03	4.77	6.55	4.44	22.9	3.8	47	12	28	Dia. 1
AEC 2504 34 4D	9.69	6.52	9.14	6.21	34.3	5.8	54	12	28	Dia. 2
AEC Plus 3001 13 4D	3.62	2.47	3.26	2.21	12.8	2.2	28	12	19	Dia. 4
AEC Plus 3001 17 4D	3.79	2.50	3.59	2.44	17.1	2.9	33	12	22	Dia. 4
AEC Plus 3002 26 4D	6.94	4.41	6.77	4.57	25.7	4.3	40	12	28	Dia. 4
AEC Plus 3002 34 4D	7.60	5.01	7.26	4.96	34.3	5.8	48	12	28	Dia. 4
AEC Plus 3003 39 4D	10.78	7.35	9.92	6.74	38.6	6.5	59	12	28	Dia. 4
AEC Plus 3003 51 4D	11.52	7.78	10.18	6.92	51.4	8.7	68	12	28	Dia. 4
AEC Plus 3004 51 4D	14.41	9.87	12.26	8.30	51.4	8.7	76	15	28	Dia. 4
AEC Plus 3004 69 4D	15.07	10.37	12.06	8.16	68.6	11.5	88	15	28	Dia. 4

EVAPORATORS/ 蒸发器 HFC/HFO(A2L)

AEC & AEC Plus SERIES EVAPORATOR

蒸发器系列 AEC & AEC Plus

FIN SPACING 4 mm, with electrical defrost. Rt>=0°C

片距4mm, 带电加热。库温>=0°C

Model/ 型号	Axial Fans/ 轴流风机							Electric Defrost/ 电化霜		
	Diameter 直径 (Φ mm)	N°	Voltage/ 电压 (V, 50Hz)	Power/ 功率 (W)	Current/ 电流 (A)	Air Flow/ 风量 (m3/h)	Air Throw/ 射程 (m)	Coil/ 内芯 (W)	Drain Pan/ 接水盘 (W)	Total/ 总 功率 (W)
AEC 2501 05 4D	250	1	1 ~ 230	50	0.2	683	5	1*230	1*230	460
AEC 2501 06 4D	250	1	1 ~ 230	50	0.2	600	4	1*230	1*230	460
AEC 2501 07 4D	250	1	1 ~ 230	50	0.2	847	4	1*320	1*320	640
AEC 2501 09 4D	250	1	1 ~ 230	50	0.2	786	4	1*320	1*320	640
AEC 2502 12 4D	250	2	1 ~ 230	100	0.5	1202	5	1*410	1*410	820
AEC 2502 18 4D	250	2	1 ~ 230	100	0.5	1572	5	1*590	1*590	1180
AEC 2503 17 4D	250	3	1 ~ 230	150	0.7	1801	6	1*585	1*585	1170
AEC 2503 26 4D	250	3	1 ~ 230	150	0.7	2358	6	1*800	1*800	1600
AEC 2504 23 4D	250	4	1 ~ 230	200	0.9	2404	7	1*740	1*740	1480
AEC 2504 34 4D	250	4	1 ~ 230	200	0.9	3145	7	1*1060	1*1060	2120
AEC Plus 3001 13 4D	300	1	1 ~ 230	80	0.4	963	9	2*320	1*320	960
AEC Plus 3001 17 4D	300	1	1 ~ 230	80	0.4	858	6	3*320	2*320	1600
AEC Plus 3002 26 4D	300	2	1 ~ 230	160	0.8	1930	10	2*585	1*585	1755
AEC Plus 3002 34 4D	300	2	1 ~ 230	160	0.8	1718	8	3*585	2*585	2925
AEC Plus 3003 39 4D	300	3	1 ~ 230	240	1.2	2893	13	2*800	1*800	2400
AEC Plus 3003 51 4D	300	3	1 ~ 230	240	1.2	2576	9	3*800	2*800	4000
AEC Plus 3004 51 4D	300	4	1 ~ 230	320	1.6	3857	15	2*1060	1*1060	3180
AEC Plus 3004 69 4D	300	4	1 ~ 230	320	1.6	3435	11	3*1060	2*1060	5300

EVAPORATORS/ 蒸发器 HFC/HFO(A2L)

COMPACT-CEILING AIR TYPE EVAPORATORS

HFC/HFO(A2L)

紧凑型蒸发器

FIN SPACING 6 mm, with electrical defrost. Rt>=-18°C

片距6mm, 带电化霜库温>=-18°C

Model / 型号	Capacity / 制冷量 R454C (kW)		Capacity / 制冷量 R1234yf (kW)		Surface/ 面积 (m ²)	Tube Volume/ 管容积 (dm ³)	N.W/ 净重 (kg)	Connection/ 接口尺寸 (ø mm)		Di- men- sion 尺寸 (mm)
	t _e = -8°C	t _e = -25°C	t _e = -8°C	t _e = -25°C				Inlet/ 进口	Outlet/ 出口	
	DT1=8K	DT1=7K	DT1=8K	DT1=7K						
AEC 2501 03 6D	0.77	0.59	0.80	0.57	2.9	0.7	11	12	12	Dia. 1
AEC 2501 04 6D	1.00	0.73	0.95	0.64	3.9	1.0	12	12	12	Dia. 1
AEC 2501 05 6D	1.15	0.82	1.05	0.70	4.4	1.1	13	12	12	Dia. 2
AEC 2501 06 6D	1.42	1.00	1.20	0.75	5.9	1.4	16	12	12	Dia. 2
AEC 2502 08 6D	2.02	1.47	1.95	1.33	7.9	1.9	18	12	19	Dia. 1
AEC 2502 12 6D	2.86	2.02	2.48	1.56	11.8	2.9	22	12	19	Dia. 2
AEC 2503 12 6D	3.03	2.20	2.94	2.03	11.8	2.9	31	12	22	Dia. 1
AEC 2503 18 6D	4.18	2.99	4.00	2.71	17.7	4.3	41	12	28	Dia. 2
AEC 2504 16 6D	4.05	2.95	3.94	2.73	15.7	3.8	46	12	28	Dia. 1
AEC 2504 24 6D	5.40	3.94	5.38	3.73	23.6	5.8	53	12	28	Dia. 2
AEC Plus 3001 09 6D	2.16	1.55	2.02	1.33	8.8	2.2	28	12	19	Dia. 4
AEC Plus 3001 12 6D	2.29	1.66	2.29	1.55	11.8	2.9	33	12	22	Dia. 4
AEC Plus 3002 18 6D	3.83	2.91	4.02	2.92	17.7	4.3	39	12	28	Dia. 4
AEC Plus 3002 24 6D	4.60	3.34	4.63	3.17	23.6	5.8	47	12	28	Dia. 4
AEC Plus 3003 27 6D	6.54	4.68	6.40	4.18	26.5	6.5	57	12	28	Dia. 4
AEC Plus 3003 35 6D	7.43	5.19	6.62	4.24	35.4	8.7	66	12	28	Dia. 4
AEC Plus 3004 35 6D	8.94	6.32	7.73	4.89	35.4	8.7	74	15	28	Dia. 4
AEC Plus 3004 47 6D	9.83	6.90	7.92	5.16	47.2	11.5	86	15	28	Dia. 4

EVAPORATORS/ 蒸发器 HFC/HFO(A2L)

AEC & AEC Plus SERIES EVAPORATOR

蒸发器系列 AEC & AEC Plus

FIN SPACING 6 mm, with electrical defrost. Rt>=-18°C

片距6mm, 带电化霜库温>=-18°C

Model/ 型号	Axial Fans/ 轴流风机							Electric Defrost/ 电化霜		
	Diameter 直径 (Φ mm)	N°	Voltage/ 电压 (V, 50Hz)	Power/ 功率 (W)	Current/ 电流 (A)	Air Flow/ 风量 (m3/h)	Air Throw/ 射程 (m)	Coil/ 内芯 (W)	Drain Pan/ 接水盘 (W)	Total/ 总 功率 (W)
AEC 2501 03 6D	250	1	1 ~ 230	50	0.2	747	6	1*230	1*230	460
AEC 2501 04 6D	250	1	1 ~ 230	50	0.2	660	5	1*230	1*230	460
AEC 2501 05 6D	250	1	1 ~ 230	50	0.2	889	4	1*320	1*320	640
AEC 2501 06 6D	250	1	1 ~ 230	50	0.2	831	4	1*320	1*320	640
AEC 2502 08 6D	250	2	1 ~ 230	100	0.5	1321	5	1*410	1*410	820
AEC 2502 12 6D	250	2	1 ~ 230	100	0.5	1663	5	1*590	1*590	1180
AEC 2503 12 6D	250	3	1 ~ 230	150	0.7	1981	7	1*585	1*585	1170
AEC 2503 18 6D	250	3	1 ~ 230	150	0.7	2495	6	1*800	1*800	1600
AEC 2504 16 6D	250	4	1 ~ 230	200	0.9	2643	7	1*740	1*740	1480
AEC 2504 24 6D	250	4	1 ~ 230	200	0.9	3327	8	1*1060	1*1060	2120
AEC Plus 3001 09 6D	300	1	1 ~ 230	80	0.4	1050	10	2*320	1*320	960
AEC Plus 3001 12 6D	300	1	1 ~ 230	80	0.4	935	7	3*320	2*320	1600
AEC Plus 3002 18 6D	300	2	1 ~ 230	160	0.8	2105	12	2*585	1*585	1755
AEC Plus 3002 24 6D	300	2	1 ~ 230	160	0.8	1871	8	3*585	2*585	2925
AEC Plus 3003 27 6D	300	3	1 ~ 230	240	1.2	3154	14	2*800	1*800	2400
AEC Plus 3003 35 6D	300	3	1 ~ 230	240	1.2	2807	10	3*800	2*800	4000
AEC Plus 3004 35 6D	300	4	1 ~ 230	320	1.6	4204	17	2*1060	1*1060	3180
AEC Plus 3004 47 6D	300	4	1 ~ 230	320	1.6	3742	12	3*1060	2*1060	5300

EVAPORATORS/ 蒸发器 HFC/HFO(A2L)

COMPACT-CEILING AIR TYPE EVAPORATORS

HFC/HFO(A2L)

紧凑型蒸发器

FIN SPACING 9 mm, with electrical defrost. Rt>=-35°C

片距9mm, 带电化霜库温>=-35°C

Model / 型号	Capacity / 制冷量 R454C (kW)		Capacity / 制冷量 R1234yf (kW)		Surface/ 面积 (m ²)	Tube Volume/ 管容积 (dm ³)	N.W/ 净重 (kg)	Connection/ 接口尺寸 (ø mm)		Di- men- sion 尺寸 (mm)
	t _e = -8°C	t _e = -25°C	t _e = -8°C	t _e = -25°C				Inlet/ 进口	Outlet/ 出口	
	DT1=8K	DT1=7K	DT1=8K	DT1=7K						
AEC 2501 02 9D	0.60	0.46	0.63	0.46	2.1	0.7	11	12	12	Dia. 1
AEC 2501 03 9D	0.82	0.60	0.81	0.55	2.7	1.0	13	12	12	Dia. 1
AEC 2501 04 9D	1.18	0.82	1.04	0.66	4.1	1.4	16	12	12	Dia. 2
AEC 2502 06 9D	1.64	1.21	1.65	1.14	5.5	1.9	18	12	12	Dia. 1
AEC 2502 08 9D	2.37	1.65	2.13	1.38	8.2	2.9	22	12	19	Dia. 2
AEC 2503 08 9D	2.47	1.82	2.50	1.73	8.2	2.9	31	12	22	Dia. 1
AEC 2503 12 9D	3.34	2.42	3.35	2.28	12.3	4.3	40	12	28	Dia. 2
AEC 2504 11 9D	3.30	2.43	3.34	2.32	11.0	3.8	45	12	28	Dia. 1
AEC 2504 16 9D	4.31	3.17	4.43	3.10	16.4	5.8	51	12	28	Dia. 2
AEC Plus 3001 06 9D	1.83	1.32	1.78	1.19	6.2	2.2	27	12	19	Dia. 4
AEC Plus 3001 08 9D	2.01	1.48	2.04	1.41	8.2	2.9	32	12	22	Dia. 4
AEC Plus 3002 12 9D	3.19	2.46	3.39	2.51	12.3	4.3	38	12	28	Dia. 4
AEC Plus 3002 16 9D	4.04	2.97	4.13	2.88	16.4	5.8	46	12	28	Dia. 4
AEC Plus 3003 19 9D	5.52	4.00	5.43	3.70	18.5	6.5	55	12	28	Dia. 4
AEC Plus 3003 25 9D	6.65	4.65	6.14	3.93	24.7	8.7	63	12	28	Dia. 4
AEC Plus 3004 25 9D	7.74	5.46	6.93	4.48	24.7	8.7	72	15	28	Dia. 4
AEC Plus 3004 33 9D	8.93	6.26	7.44	4.52	32.9	11.5	82	15	28	Dia. 4

AEC & AEC Plus SERIES EVAPORATOR

蒸发器系列 AEC & AEC Plus

FIN SPACING 9 mm, with electrical defrost. Rt>=-35°C

片距9mm, 带电化霜库温>=-35°C

Model/ 型号	Axial Fans/ 轴流风机							Electric Defrost/ 电化霜		
	Diameter 直径 (Φ mm)	N°	Voltage/ 电压 (V, 50Hz)	Power/ 功率 (W)	Current/ 电流 (A)	Air Flow/ 风量 (m3/h)	Air Throw/ 射程 (m)	Coil/ 内芯 (W)	Drain Pan/ 接水盘 (W)	Total/ 总 功率 (W)
AEC 2501 02 9D	250	1	1 ~ 230	50	0.2	795	6	1*230	1*230	460
AEC 2501 03 9D	250	1	1 ~ 230	50	0.2	718	4	1*320	1*320	640
AEC 2501 04 9D	250	1	1 ~ 230	50	0.2	871	4	1*320	1*320	640
AEC 2502 06 9D	250	2	1 ~ 230	100	0.5	1438	5	1*410	1*410	820
AEC 2502 08 9D	250	2	1 ~ 230	100	0.5	1744	5	1*590	1*590	1180
AEC 2503 08 9D	250	3	1 ~ 230	150	0.7	2166	7	1*585	1*585	1170
AEC 2503 12 9D	250	3	1 ~ 230	150	0.7	2624	7	1*800	1*800	1600
AEC 2504 11 9D	250	4	1 ~ 230	200	0.9	2891	8	1*740	1*740	1480
AEC 2504 16 9D	250	4	1 ~ 230	200	0.9	3499	8	1*1060	1*1060	2120
AEC Plus 3001 06 9D	300	1	1 ~ 230	80	0.4	1140	10	2*320	1*320	960
AEC Plus 3001 08 9D	300	1	1 ~ 230	80	0.4	1020	7	3*320	2*320	1600
AEC Plus 3002 12 9D	300	2	1 ~ 230	160	0.8	2286	9	2*585	1*585	1755
AEC Plus 3002 16 9D	300	2	1 ~ 230	160	0.8	2042	11	3*585	2*585	2925
AEC Plus 3003 19 9D	300	3	1 ~ 230	240	1.2	3423	14	2*800	1*800	2400
AEC Plus 3003 25 9D	300	3	1 ~ 230	240	1.2	3061	10	3*800	2*800	4000
AEC Plus 3004 25 9D	300	4	1 ~ 230	320	1.6	4561	17	2*1060	1*1060	3180
AEC Plus 3004 33 9D	300	4	1 ~ 230	320	1.6	4081	12	3*1060	2*1060	5300

EVAPORATORS/ 蒸发器 HFC/HFO(A2L)

COMPACT-CEILING AIR TYPE EVAPORATORS

HFC/HFO(A2L)

紧凑型蒸发器

FIN SPACING 4.5 mm, with electrical defrost. Rt>=0°C

片距4.5mm, 带电加热。库温>=0°C

Model / 型号	Capacity / 制冷量 R454C (kW)		Capacity / 制冷量 R1234yf (kW)		Surface/ 面积 (m ²)	Tube Volume/ 管容积 (dm ³)	N.W/ 净重 (kg)	Connection/ 接口尺寸 (ø mm)		Dimen- sion 尺寸 (mm)
	t _e = 0°C	t _e = -8°C	t _e = 0°C	t _e = -8°C				Inlet/ 进口	Out- let/ 出口	
	DT1=10K	DT1=8K	DT1=10K	DT1=8K						
AEC 3001 11 4.5D	2.15	1.31	2.08	1.42	10.4	1.5	18	12	15	Dia. 3
AEC 3001 16 4.5D	2.61	1.72	2.43	1.66	15.5	2.2	21	12	15	Dia. 3
AEC 3002 21 4.5D	4.68	3.20	3.87	2.62	20.8	3.0	32	12	15	Dia. 3
AEC 3002 32 4.5D	5.25	3.47	4.94	3.37	31.1	4.5	39	12	22	Dia. 3
AEC 3003 32 4.5D	6.69	4.69	6.31	4.29	31.1	4.5	35	12	22	Dia. 3
AEC 3003 48 4.5D	8.08	5.53	6.88	4.66	46.7	6.8	56	12	22	Dia. 3
AEC 3004 43 4.5D	9.42	6.44	7.89	5.34	41.5	6.0	60	12	22	Dia. 3
AEC 3004 64 4.5D	10.75	7.34	9.56	6.49	62.3	9.0	73	15	28	Dia. 3

EVAPORATORS / 蒸发器 HFC/HFO(A2L)

AEC & AEC Plus SERIES EVAPORATOR

蒸发器系列 AEC & AEC Plus

FIN SPACING 4.5 mm, with electrical defrost. Rt>=0°C

片距4.5mm, 带电加热。库温>=0°C

Model/ 型号	Axial Fans/ 轴流风机							Electric Defrost/ 电化霜		
	Diameter 直径 (Φ mm)	N°	Voltage/ 电压 (V, 50Hz)	Power/ 功率 (W)	Current/ 电流 (A)	Air Flow/ 风量 (m3/h)	Air Throw/ 射程 (m)	Coil/ 内芯 (W)	Drain Pan/ 接水盘 (W)	Total/ 总 功率 (W)
AEC 3001 11 4.5D	300	1	1 ~ 230	80	0.4	1157	9	2 × 335	1 × 335	1005
AEC 3001 16 4.5D	300	1	1 ~ 230	80	0.4	980	6	2 × 335	1 × 335	1005
AEC 3002 21 4.5D	300	2	1 ~ 230	160	0.8	2307	10	2 × 600	1 × 600	1800
AEC 3002 32 4.5D	300	2	1 ~ 230	160	0.8	1967	8	2 × 600	1 × 600	1800
AEC 3003 32 4.5D	300	3	1 ~ 230	240	1.2	3466	13	2 × 800	1 × 800	2400
AEC 3003 48 4.5D	300	3	1 ~ 230	240	1.2	2938	9	2 × 800	1 × 800	2400
AEC 3004 43 4.5D	300	4	1 ~ 230	320	1.6	4615	15	2 × 1060	1 × 1060	3180
AEC 3004 64 4.5D	300	4	1 ~ 230	320	1.6	3920	11	2 × 1060	1 × 1060	3180

EVAPORATORS/ 蒸发器 HFC/HFO(A2L)

COMPACT-CEILING AIR TYPE EVAPORATORS

HFC/HFO(A2L)

紧凑型蒸发器

FIN SPACING 7 mm, with electrical defrost. Rt>=-20°C

片距7mm, 带电加热。库温>=-20°C

Model / 型号	Capacity / 制冷量 R454C (kW)		Capacity / 制冷量 R1234yf (kW)		Surface/ 面积 (m ²)	Tube Volume/ 管容积 (dm ³)	N.W/ 净重 (kg)	Connection/ 接口尺寸 (ø mm)		Dimen- sion 尺寸 (mm)
	t _e = -8°C	t _e = -25°C	t _e = -8°C	t _e = -25°C				Inlet/ 进口	Out- let/ 出口	
	DT1=8K	DT1=7K	DT1=8K	DT1=7K						
AEC 3001 07 7D	0.97	0.84	1.07	0.90	6.8	1.5	17	12	15	Dia. 3
AEC 3001 10 7D	1.35	1.07	1.40	1.03	10.2	2.2	20	12	15	Dia. 3
AEC 3002 14 7D	2.60	2.06	2.25	1.54	13.7	3.0	30	12	15	Dia. 3
AEC 3002 20 7D	2.71	2.16	2.83	2.11	20.5	4.5	36	12	22	Dia. 3
AEC 3003 20 7D	3.64	2.93	3.54	2.70	20.5	4.5	32	12	22	Dia. 3
AEC 3003 30 7D	4.62	3.49	4.08	3.18	30.8	6.8	52	12	22	Dia. 3
AEC 3004 28 7D	5.23	4.15	4.58	3.14	27.4	6.0	57	12	22	Dia. 3
AEC 3004 41 7D	6.08	4.58	5.59	3.94	41.0	9.0	68	15	28	Dia. 3

EVAPORATORS/ 蒸发器 HFC/HFO(A2L)

AEC & AEC Plus SERIES EVAPORATOR

蒸发器系列 AEC & AEC Plus

FIN SPACING 7 mm, with electrical defrost. Rt>=-20°C

片距7mm, 带电加热。库温>=-20°C

Model/ 型号	Axial Fans/ 轴流风机							Electric Defrost/ 电化霜		
	Diameter 直径 (Φ mm)	N°	Voltage/ 电压 (V, 50Hz)	Power/ 功率 (W)	Current/ 电流 (A)	Air Flow/ 风量 (m3/h)	Air Throw/ 射程 (m)	Coil/ 内芯 (W)	Drain Pan/ 接水盘 (W)	Total/ 总 功率 (W)
AEC 3001 07 7D	300	1	1 ~ 230	80	0.4	1250	10	2 × 335	1 × 335	1005
AEC 3001 10 7D	300	1	1 ~ 230	80	0.4	1083	7	2 × 335	1 × 335	1005
AEC 3002 14 7D	300	2	1 ~ 230	160	0.8	2487	12	2 × 600	1 × 600	1800
AEC 3002 20 7D	300	2	1 ~ 230	160	0.8	2169	8	2 × 600	1 × 600	1800
AEC 3003 20 7D	300	3	1 ~ 230	240	1.2	3736	14	2 × 800	1 × 800	2400
AEC 3003 30 7D	300	3	1 ~ 230	240	1.2	3246	10	2 × 800	1 × 800	2400
AEC 3004 28 7D	300	4	1 ~ 230	320	1.6	4975	17	2 × 1060	1 × 1060	3180
AEC 3004 41 7D	300	4	1 ~ 230	320	1.6	4331	12	2 × 1060	1 × 1060	3180

EVAPORATORS/ 蒸发器 HFC/HFO(A2L)

COMPACT-CEILING AIR TYPE EVAPORATORS

HFC/HFO(A2L)

紧凑型蒸发器

FIN SPACING 10 mm, with electrical defrost. Rt>=-35°C

片距10mm, 带电加热。库温>=-20°C

Model / 型号	Capacity / 制冷量 R454C (kW)		Capacity / 制冷量 R1234yf (kW)		Surface/ 面积 (m ²)	Tube Volume/ 管容积 (dm ³)	N.W/ 净重 (kg)	Connection/ 接口尺寸 (ø mm)		Dimen- sion 尺寸 (mm)
	t _e = -8°C	t _e = -25°C	t _e = -8°C	t _e = -25°C				Inlet/ 进口	Out- let/ 出口	
	DT1=8K	DT1=7K	DT1=8K	DT1=7K						
AEC 3001 05 10D	0.77	0.67	0.84	0.72	4.9	1.5	17	12	15	Dia. 3
AEC 3001 07 10D	1.10	0.89	1.17	0.88	7.4	2.2	20	12	15	Dia. 3
AEC 3002 10 10D	2.19	1.70	1.97	1.47	9.8	3.0	30	12	15	Dia. 3
AEC 3002 15 10D	2.20	1.78	2.36	1.80	14.8	4.5	36	12	22	Dia. 3
AEC 3003 15 10D	2.89	2.36	3.02	2.33	14.8	4.5	32	12	22	Dia. 3
AEC 3003 22 10D	3.91	2.93	3.59	2.50	22.1	6.8	52	12	22	Dia. 3
AEC 3004 20 10D	4.40	3.42	3.99	2.76	19.7	6.0	56	12	22	Dia. 3
AEC 3004 29 10D	5.00	3.83	4.87	3.51	29.5	9.0	67	15	28	Dia. 3

EVAPORATORS / 蒸发器 HFC/HFO(A2L)

AEC & AEC Plus SERIES EVAPORATOR

蒸发器系列 AEC & AEC Plus

FIN SPACING 10 mm, with electrical defrost. Rt>=-35°C

片距10mm, 带电加热。库温>=-20°C

Model/ 型号	Axial Fans/ 轴流风机							Electric Defrost/ 电化霜		
	Diameter 直径 (Φ mm)	N°	Voltage/ 电压 (V, 50Hz)	Power/ 功率 (W)	Current/ 电流 (A)	Air Flow/ 风量 (m3/h)	Air Throw/ 射程 (m)	Coil/ 内芯 (W)	Drain Pan/ 接水盘 (W)	Total/ 总 功率 (W)
AEC 3001 05 10D	300	1	1 ~ 230	80	0.4	1315	10	2 × 335	1 × 335	1005
AEC 3001 07 10D	300	1	1 ~ 230	80	0.4	1165	7	2 × 335	1 × 335	1005
AEC 3002 10 10D	300	2	1 ~ 230	160	0.8	2610	9	2 × 600	1 × 600	1800
AEC 3002 15 10D	300	2	1 ~ 230	160	0.8	2332	11	2 × 600	1 × 600	1800
AEC 3003 15 10D	300	3	1 ~ 230	240	1.2	3922	14	2 × 800	1 × 800	2400
AEC 3003 22 10D	300	3	1 ~ 230	240	1.2	3489	10	2 × 800	1 × 800	2400
AEC 3004 20 10D	300	4	1 ~ 230	320	1.6	5221	17	2 × 1060	1 × 1060	3180
AEC 3004 29 10D	300	4	1 ~ 230	320	1.6	4656	12	2 × 1060	1 × 1060	3180

EVAPORATORS/ 蒸发器 HFC/HFO(A2L)

AVAILABLE OPTIONS FOR AEC SERIES:

Defrost options:

- Without defrost (air)
- D: Electrical defrost: standard model
- HG: hot gas
- W: water
- HGD: hot gas defrost for coil and electrical defrost for tray
- WD: water and electrical

Tube material options:

- Copper: standard models
- 1: Stainless steel AISI SUS304

Coil protection options:

- Aluminium fins: standard models
- Fins with GOLDFIN anti-corrosion high resistance coating.

Fan options:

- EC Fans

Casing options:

- White powder-coated painted aluminium: standard models
- 2: stainless steel AISI SUS304

Other options:

- Thermal protector for defrosting electrical AEAters

AEC 系列选配件:

化霜:

- 无化霜 (空气)
- D: 电化霜: 标准型号
- HG: 热氟
- W: 水
- HGD: 内芯热氟化霜, 接水盘电化霜
- WD: 水和电化霜

盘管材质:

- 铜管: 标准型号
- 1: 304不锈钢

内芯材质:

- 铝箔: 标准型号
- 高防腐性的金色铝箔

风机:

- EC风机

外壳:

- 铝制白色喷涂: 标准型号
- 2: 304不锈钢

其他:

- 电化霜热保护器

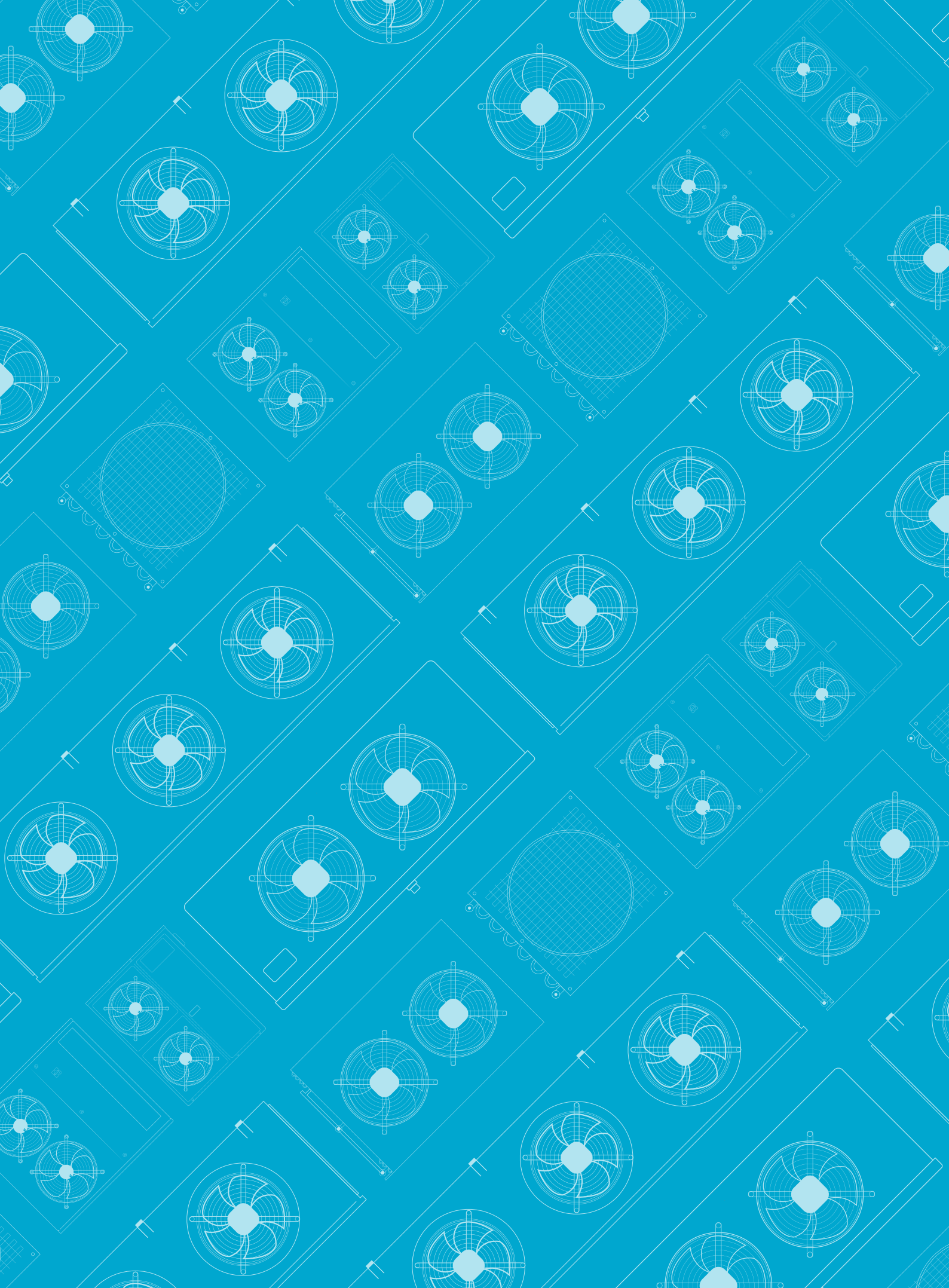



HIGH EFFICIENCY COMPACT-CEILING AIR TYPE EVAPORATORS EVAPORADORES EVAPORADORES COMPACTOS TIPO CUÑA DE ALTA EFICIENCIA

The AEJ range of compact-ceiling air type evaporators has been designed for use in low height commercial cold rooms for the preservation of fresh and frozen products.

The exchange coils used in the AEJ range are highly efficient with special profile aluminum fins and $\varnothing 9.52$ mm internally grooved copper tubes, with a reduced internal volume to reduce the necessary refrigerant charge, meeting the needs of the different international regulations for the reduction of gases with high greenhouse effect. They are supplied clean and tested under a pressure of 30 bar.

The AEJ range is subdivided into two series with different fin pitches depending on the chamber temperature:

- AEJ: For medium room temperatures ($R_t \geq -10^\circ\text{C}$) with alternate fin pitch 3.2/6.4 mm and electric defrost.

- AEJ Plus: For low room temperatures ($R_t \geq -25^\circ\text{C}$) with alternate fin pitch 4.5/9 mm and electric defrost.

AEJ SERIES EVAPORATOR EVAPORADORES SERIE AEJ

AEJ系列紧凑型蒸发器适用于空间高度较小的冷库的冷冻冷藏需求。

AEJ的高效内芯采用铝箔和 $\varnothing 9.52$ mm内螺纹铜管，通过减少管容积来降低冷媒充注量，满足全球温室气体的减排需求。所有内芯均经过清洁和30bar保压测试。

AEJ分为两种系列，有不同的片距，满足不同温度的应用：

- AEJ: 中温库用($R_t \geq -10^\circ\text{C}$)，片距3.2/6.4 mm，带电加热
- AEJ Plus: 低温库用($R_t \geq -25^\circ\text{C}$)，片距4.5/9 mm，带电加热

AEJ & AEJ PlusSERIES EVAPORATOR

蒸发器系列 AEJ & AEJ Plus

The standard electric fans used in this range have the following characteristics:

-Single-phase 230V/1/50 Hz with shaded pole motor, ø200 mm, with grid and short nozzle. Operating temperature -30°C to +40°C.

White powder-coated aluminium casing with high resistance to corrosion and impacts.

In models with electric defrost, stainless steel electric heaters covered by aluminum tubes are used, located in the finned package and in the drip tray to avoid steam problems and make easy replacement.

The electrical parts are connected to an earth terminal, inside a connection box with access holes equipped with cable glands with IP 65 protection.

For performance at work points other than those in this catalog, use the "Unit Selector Hybrid HISPANIA" software.

For special applications and additional information consult our Technical Department.

标准的风机配置如下:

-单相230V/1/50Hz罩极电机, 带K网罩和短出风口. 工作温度-40°C至+40°C。

白色喷涂的铝制外壳, 有较高的防腐蚀和抗震性能。

电化霜的电加热管套有不锈钢管, 固定于翅片和接水盘内, 可隔绝水蒸气, 且方便维护。

所有电器有效接地。电线均接入防护等级IP65的电器盒内。

可使用"Unit Selector Hybrid HISPANIA"选型软件查询样册以外的工况性能。

更多需求和信息请联系Hispania。

EVAPORATORS / 蒸发器 HFC/HFO(A2L)

AEJ Plus 1D S1 2 GF

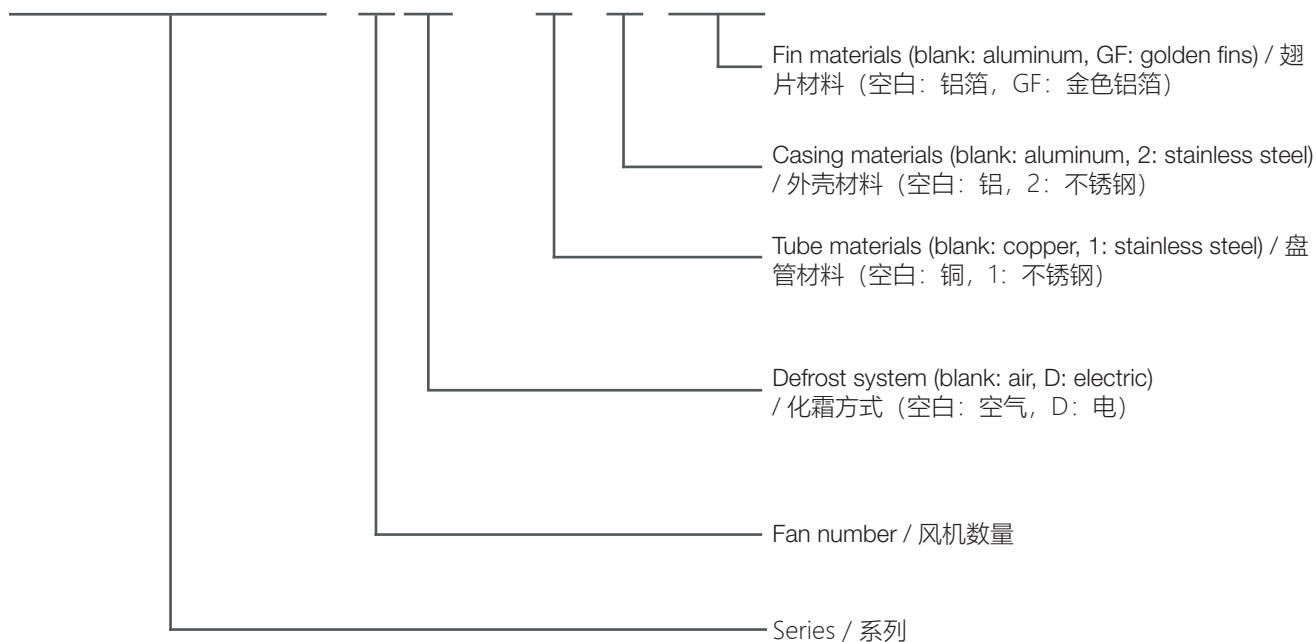

EVAPORATORS / 蒸发器 HFC/HFO(A2L)

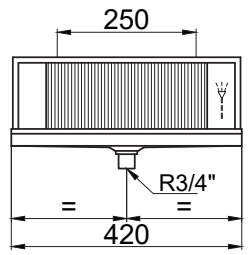
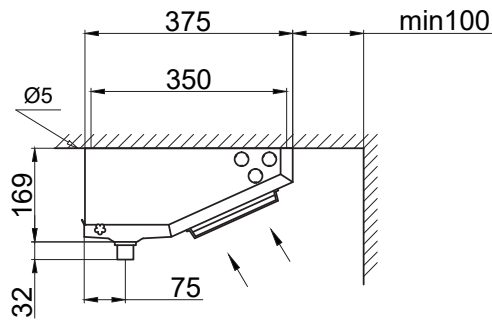

AEJ-1D

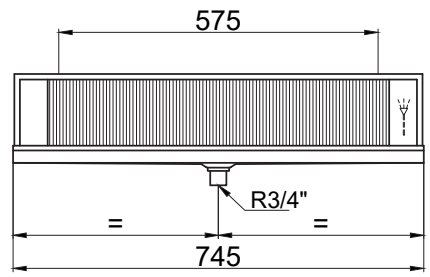

AEJ-2D

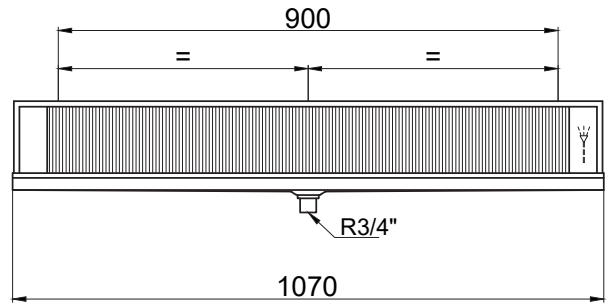

AEJ-3D

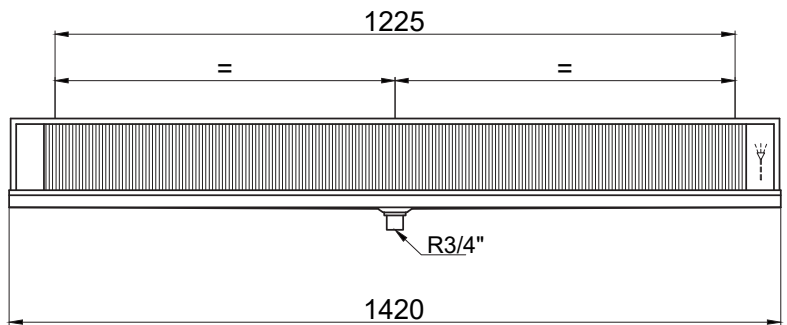

AEJ-4D

AEJ & AEJ PlusSERIES EVAPORATOR

蒸发器系列 AEJ & AEJ Plus

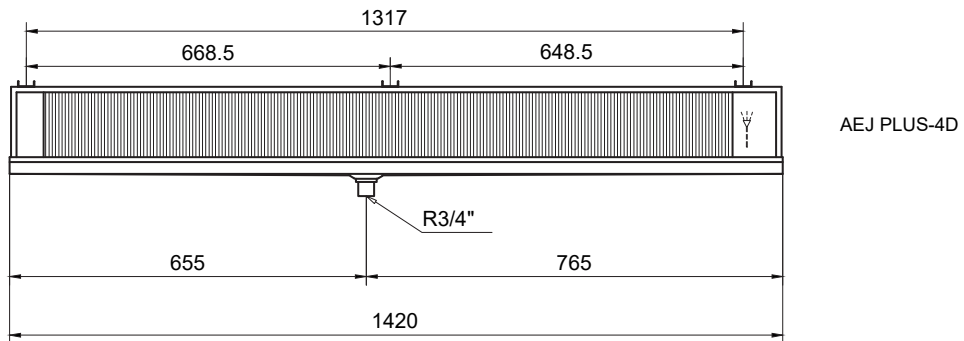
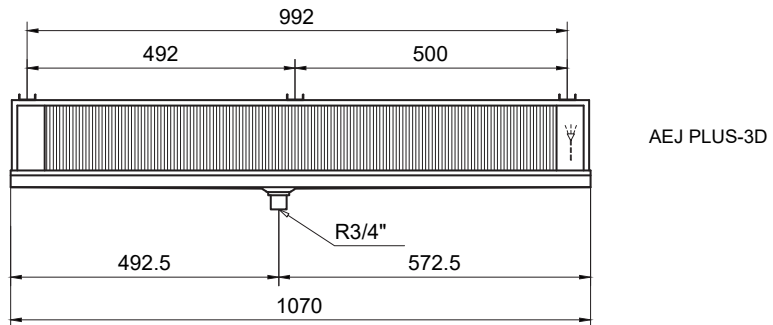
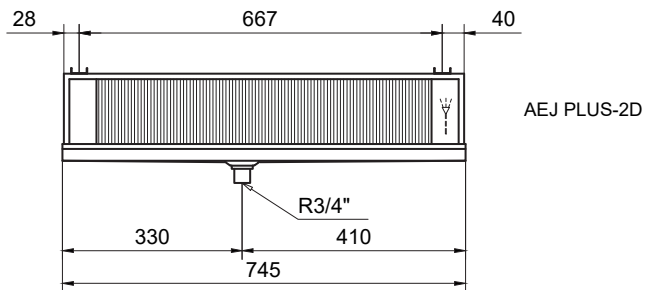
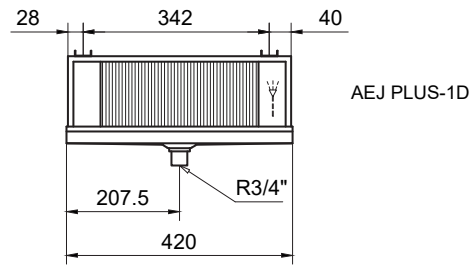
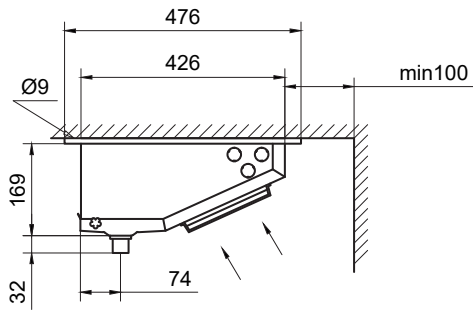

FIN SPACING 3.2/6.4 mm, with electrical defrost. Rt>=-10°C

片距3.2/6.4 mm,带电加热。库温>=-10°C

Model / 型号	Capacity / 制冷量 R454C (kW)		Capacity / 制冷量 R1234yf (kW)		Surface/ 面积 (m ²)	Tube Volume/ 管容积 (dm ³)	N.W/ 净重 (kg)	Connection/ 接口尺寸	
	t _e = 0°C	t _e = -8°C	t _e = 0°C	t _e = -8°C				Inlet/ 进口	Outlet/ 出口
	DT1=10K	DT1=8K	DT1=10K	DT1=8K					
AEJ-1D	1.22	0.84	1.03	0.71	2.9	0.6	5	1/2"	3/8"
AEJ-2D	2.41	1.60	2.32	1.58	5.7	1.2	9	1/2"	1/2"
AEJ-3D	3.70	2.57	3.28	2.27	8.6	1.8	12	1/2"	1/2"
AEJ-4D	4.90	3.38	4.60	3.16	11.5	2.5	16	1/2"	1/2"

Model/ 型号	Axial Fans/ 轴流风机							Electric Defrost/ 电化霜	
	Diameter 直径 (Φ mm)	N°	Voltage/ 电压 (V, 50Hz)	Power/ 功率 (W)	Current/ 电流 (A)	Air Flow/ 风量 (m ³ /h)	Air Throw/ 射程 (m)	Coil/ 内芯 (W)	Total/ 总功率 (W)
AEJ-1D	200	1	1 ~ 230	38	0.2	348	5	1 × 165	165
AEJ-2D	200	2	1 ~ 230	76	0.5	696	6	1 × 310	310
AEJ-3D	200	3	1 ~ 230	114	0.7	1043	7	1 × 450	450
AEJ-4D	200	4	1 ~ 230	152	0.9	1391	9	1 × 590	590

AEJ & AEJ PlusSERIES EVAPORATOR

蒸发器系列 AEJ & AEJ Plus

FIN SPACING 4.5/9 mm, with electrical defrost. Rt>=-25°C

片距4.5/9 mm,带电加热。库温>=-25°C

Model / 型号	Capacity / 制冷量 R454C (kW)		Capacity / 制冷量 R1234yf (kW)		Surface/ 面积 (m ²)	Tube Volume/ 管容积 (dm ³)	N.W/ 净重 (kg)	Connection/ 接口尺寸	
	t _e = -8°C	t _e = -25°C	t _e = -8°C	t _e = -25°C				Inlet/ 进口	Outlet/ 出口
	DT1=10K	DT1=8K	DT1=10K	DT1=8K					
AEJ Plus-1D	0.92	0.65	0.76	0.53	2.1	0.6	5	1/2"	3/8"
AEJ Plus-2D	1.75	1.28	1.70	1.18	4.2	1.2	9	1/2"	1/2"
AEJ Plus-3D	2.80	2.01	2.41	1.51	6.4	1.8	13	1/2"	1/2"
AEJ Plus-4D	3.67	2.64	3.42	2.29	8.5	2.5	18	1/2"	1/2"

Model/ 型号	Axial Fans/ 轴流风机							Electric Defrost/ 电化霜	
	Diameter 直径 (Φ mm)	N°	Voltage/ 电压 (V, 50Hz)	Power/ 功率 (W)	Current/ 电流 (A)	Air Flow/ 风量 (m ³ /h)	Air Throw/ 射程 (m)	Coil/ 内芯 (W)	Total/ 总 功率 (W)
AEJ Plus-1D	254	1	1 ~ 230	73	0.5	498	12	1 × 165	165
AEJ Plus-2D	254	2	1 ~ 230	146	1.0	996	14	1 × 310	310
AEJ Plus-3D	254	3	1 ~ 230	219	1.5	1492	17	1 × 450	450
AEJ Plus-4D	254	4	1 ~ 230	292	2.0	1990	21	1 × 590	590

AVAILABLE OPTIONS FOR AEJ SERIES:**Defrost options:**

- Without defrost (air)
- D: Electrical defrost: standard model

Tube material options:

- Copper: standard models
- SS1: Stainless steel AISI SUS304

Coil protection options:

- Aluminium fins: standard models
- Fins with GOLDFIN anti-corrosion high resistance coating.

Fan options:

- EC Fans

Casing options:

- White powder-coated painted aluminium: standard models
- 2: stainless steel AISI SUS304

Other options:

- Thermal protector for defrosting electrical AEAters

AEJ 系列选配件:**化霜:**

- 无化霜 (空气)
- D: 电化霜: 标准型号

盘管材质:

- 铜管: 标准型号
- SS1: 304不锈钢

内芯材质:

- 铝箔: 标准型号
- 高防腐性的金色铝箔

风机:

- EC风机

外壳:

- 铝制白色喷涂: 标准型号
- 2: 304不锈钢

其他:

- 电化霜热保护器

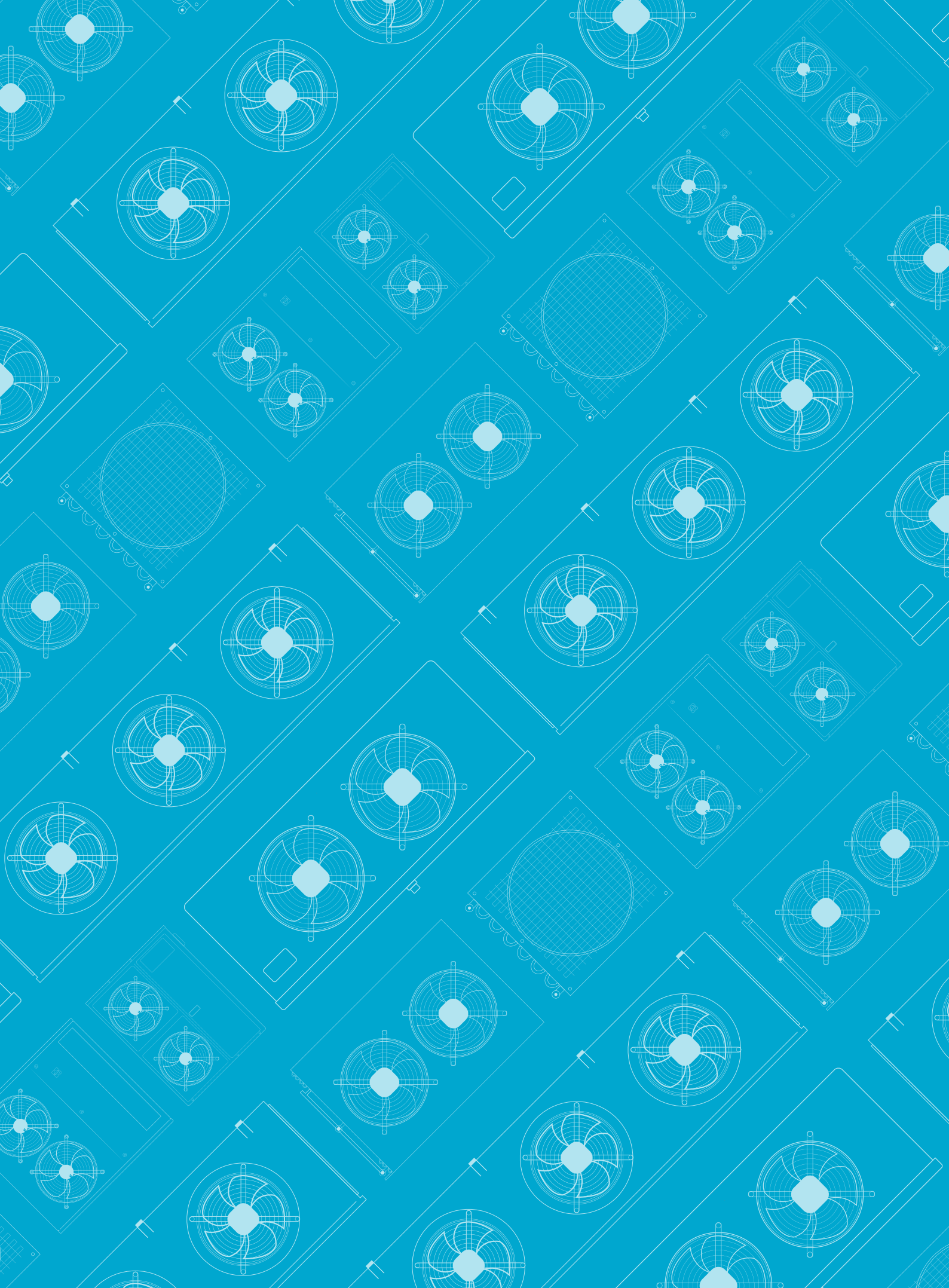



DUAL DISCHARGE CEILING AIR TYPE EVAPORATORS EVAPORADORES TIPO TECHO

The AED range of compact-ceiling air type evaporators has been designed for use in low/medium height cold rooms for the preservation of fresh and frozen products and processing rooms as well.

The exchange coils used in the AED range are built with geometries of recognized high efficiency, with special profile aluminum fins and $\varnothing 9.52$ mm (AED 25XX) or $\varnothing 12$ mm (AED 35XX) internally grooved or $\varnothing 15$ mm (AEC 40XX and above) high quality copper tubes, with high heat transfer coefficient. They are supplied clean and tested under a pressure of 30 bar.

The AED range has models with different fin pitch depending on the temperature of the cold room/processing room:

For high temp. in the cold/processing room:

- AED 25XX XX 4.5X: with 4.5 mm pitch ($R_t \geq 0^\circ\text{C}$)
- AED 35XX XX 4X and above: with 4 mm pitch ($R_t \geq 0^\circ\text{C}$)

For medium temperatures in the cold room:

- AED 35XX XX 6X: with 6 mm pitch ($R_t \geq -18^\circ\text{C}$)
- AED 40XX XX 7X and above: with 7 mm pitch ($R_t \geq -20^\circ\text{C}$)

For low temperatures in the cold room:

- AED Plus 40XX XX 9X and above: with 9 mm pitch ($R_t \geq -35^\circ\text{C}$)
- AED 40XX XX 10X and above: with 10 mm pitch ($R_t \geq -35^\circ\text{C}$)

AED SERIES EVAPORATOR 蒸发器系列 AED

AED系列双出风蒸发器适用于中低空间高度冷库的冷冻冷藏需求，同时也能应用于工作间。

AED的高效内芯采用铝箔和 $\varnothing 9.52$ mm(AED 25XX)或者 $\varnothing 12$ mm (AED 35XX)内螺纹铜管和 $\varnothing 15$ mm(AEC 40XX及以上)光管，具有较高的换热性能。所有内芯均经过清洁和30bar保压测试。

AED有多种片距，满足不同温度的应用：

高温库或工作间：

- AED 25XX XX 4.5X: 4.5mm片距 ($R_t \geq 0^\circ\text{C}$)
- AED 35XX XX 4X及以上: 4mm片距 ($R_t \geq 0^\circ\text{C}$)

中温库：

- AED 35XX XX 6X: 6mm片距 ($R_t \geq -18^\circ\text{C}$)
- AED 40XX XX 7X及以上: 7mm片距($R_t \geq -20^\circ\text{C}$)

低温库：

- AED Plus 40XX XX 9X及以上: 9mm片距($R_t \geq -35^\circ\text{C}$)
- AED 40XX XX 10X及以上: 10mm片距($R_t \geq -35^\circ\text{C}$)

AED & AED Plus SERIES EVAPORATOR

蒸发器系列 AED & AED Plus

The standard electric fans used in this range have the following characteristics:

-ø250, 350, 400 mm : Single-phase 230V/1/50 Hz with external rotor, with type K grid and nozzle (short mouth). Operating temperature -40°C to +40°C.

-ø450, 500, 630, 800 mm: three-phase 400V/3/50 Hz with external rotor, with type K grid and nozzle (short mouth). Operating temperature -40°C to +40°C.

White powder-coated aluminium casing with high resistance to corrosion and impacts.

In models with electric defrost, stainless steel electric heaters covered by aluminum tubes are used, located in the finned package and in the drip tray (depending on the model) to avoid steam problems and make easy replacement.

The electrical parts are connected to an earth terminal, inside a connection box with access holes equipped with cable glands with IP 65 protection.

For performance at work points other than those in this catalog, use the "Unit Selector Hybrid HISPANIA" software.

For special applications and additional information consult our Technical Department.

标准的风机配置如下:

-ø250, 350, 400 mm: 单相230V/1/50Hz外转子电机, 带K网罩和短出风口. 工作温度-40°C至+40°C。

-ø450, 500, 630, 800 mm: 三相400V/3/50Hz外转子电机, 带K网罩和短出风口. 工作温度-40°C至+40°C。

白色喷涂的铝制外壳, 有较高的防腐蚀和抗震性能。

电化霜的电加热管套有不锈钢管, 固定于翅片和接水盘内, 可隔绝水蒸气, 且方便维护。

所有电器有效接地。电线均接入防护等级IP65的电器盒内。

可使用"Unit Selector Hybrid HISPANIA"选型软件查询样册以外的工况性能。

更多需求和信息请联系Hispania。

EVAPORATORS / 蒸发器 HFC/HFO(A2L)

AED 4502 82 7D S1 2 3

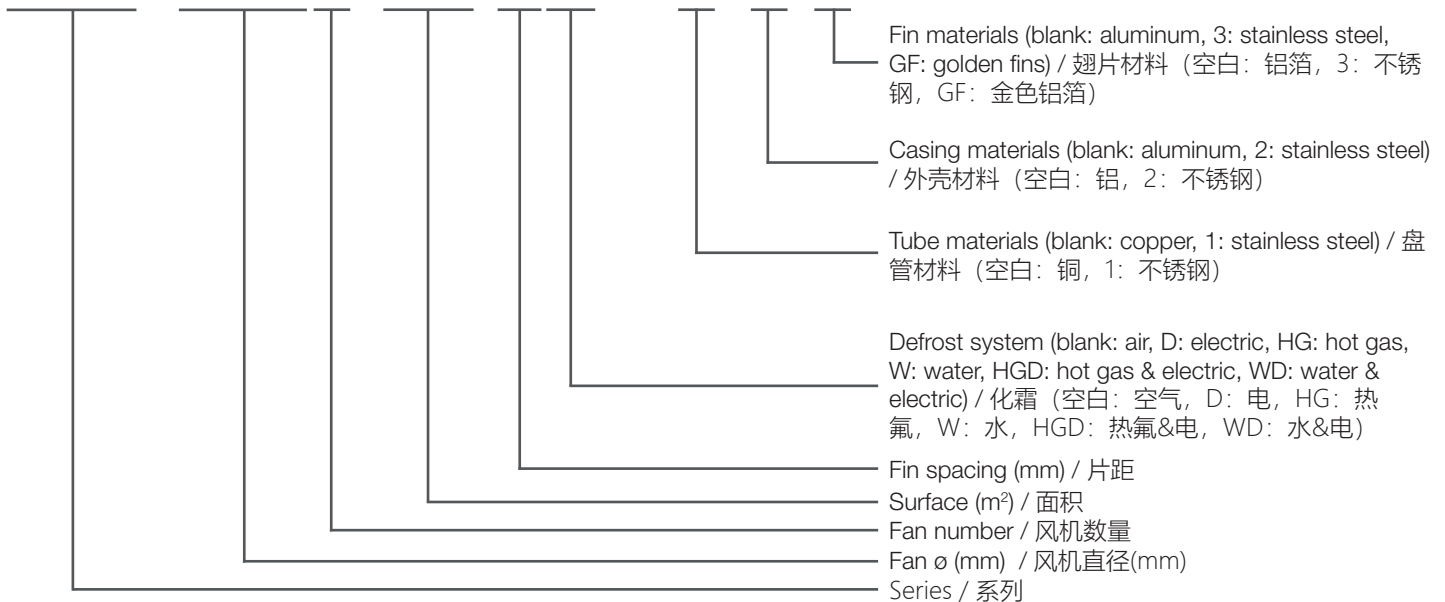

DUAL DISCHARGE CEILING AIR TYPE EVAPORATORS

双出风蒸发器

HFC/HFO(A2L)

EVAPORATORS / 蒸发器 HFC/HFO(A2L)

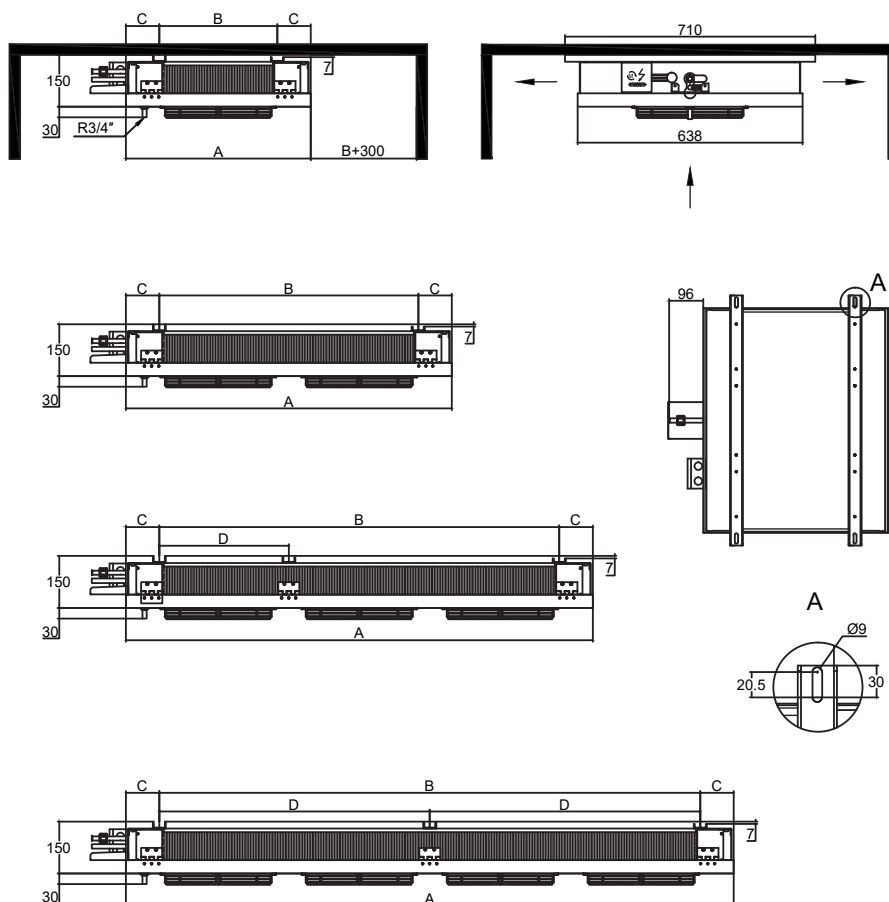

Model / 型号	Dimensions / 尺寸 (mm)			
	A	B	C	D
AED 2501...	530	335	95	
AED 2502...	930	735	95	
AED 2503...	1330	1135	95	367.5
AED 2504...	1730	1535	95	367.5

AED & AED Plus SERIES EVAPORATOR

蒸发器系列 AED & AED Plus

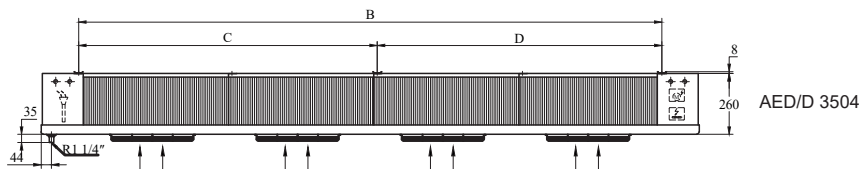
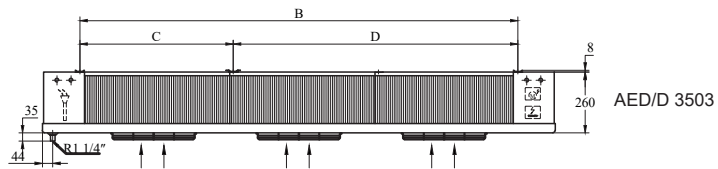
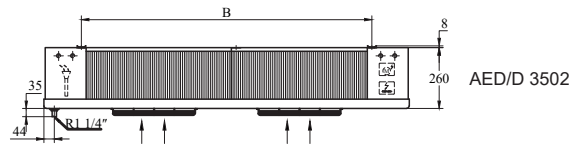
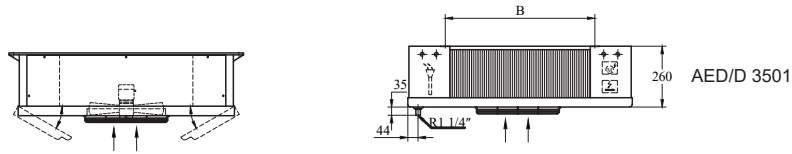
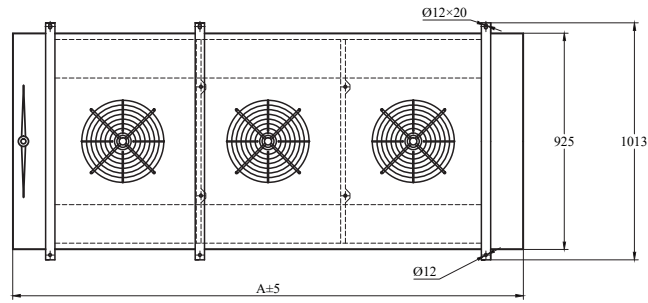

Model / 型号	Dimensions / 尺寸 (mm)			
	A	B	C	D
AED 3501...	963	640		
AED 3502...	1565	1242		
AED 3503...	2167	1844	640	1204
AED 3504...	2769	2446	1242	1204

DUAL DISCHARGE CEILING AIR TYPE EVAPORATORS

双出风蒸发器

HFC/HFO(A2L)

EVAPORATORS / 蒸发器 HFC/HFO(A2L)

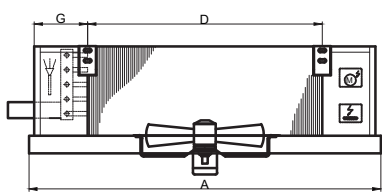
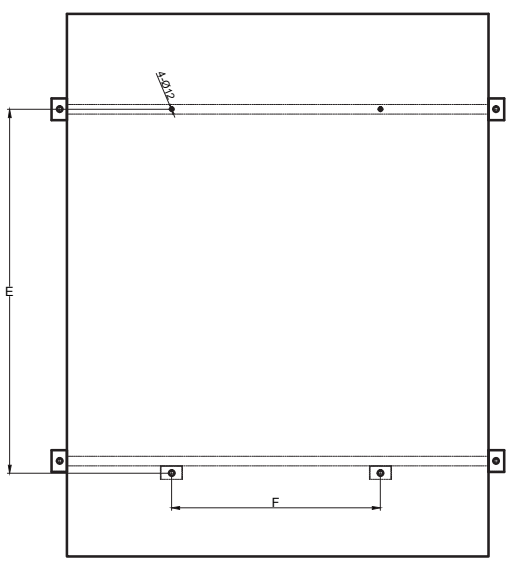
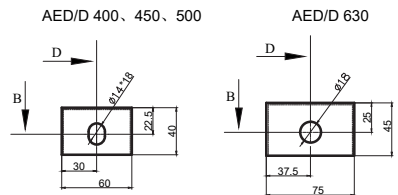
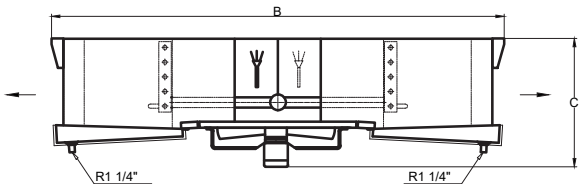

AED/D
4001/4501/5001/6301

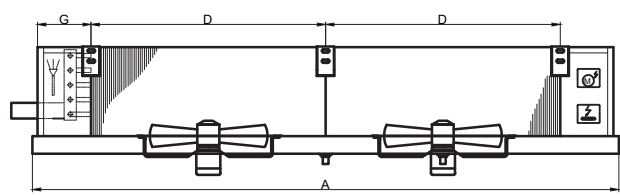

AED/D
4002/4502/5002/6302

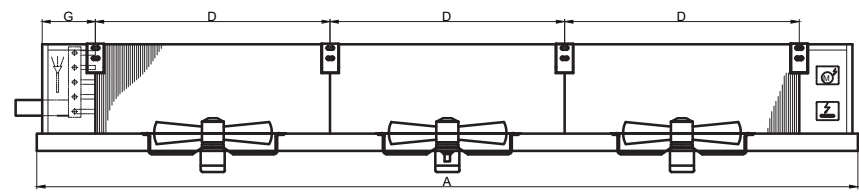

AED/D
4003/4503/5003/6303

AED & AED Plus SERIES EVAPORATOR

蒸发器系列 AED & AED Plus

Model / 型号	Dimensions / 尺寸 (mm)						
	A	B	C	D	E	F	G
AED 4001...	1000	1555	435	600	655	565	190
AED 4002...	1600	1555	435	600	1255	565	190
AED 4003...	2280	1555	435	600	1855	565	230
AED 4501...	1200	1555	450	800	855	565	190
AED 4502...	2000	1555	450	800	1655	565	190
AED 4503...	2880	1555	450	800	2455	565	230
AED 5001...	1480	1555	450	1000	1055	565	230
AED 5002...	2480	1555	450	1000	2055	565	230
AED 5003...	3520	1555	450	1000	3055	565	250
AED 6301...	1850	1935	450	1200	1255	745	315
AED 6302...	3050	1935	450	1200	2455	745	315
AED 6303...	4350	1935	450	1200	3655	745	415
*AED 6301...	1850	1935	550	1200	1255	745	315
*AED 6302...	3050	1935	550	1200	2455	745	315
*AED 6303...	4350	1935	550	1200	3655	745	315

Dimensions for models with *.

带*型号尺寸。

DUAL DISCHARGE CEILING AIR TYPE EVAPORATORS

双出风蒸发器

HFC/HFO(A2L)

EVAPORATORS / 蒸发器 HFC/HFO(A2L)

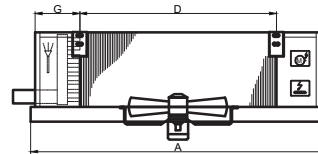
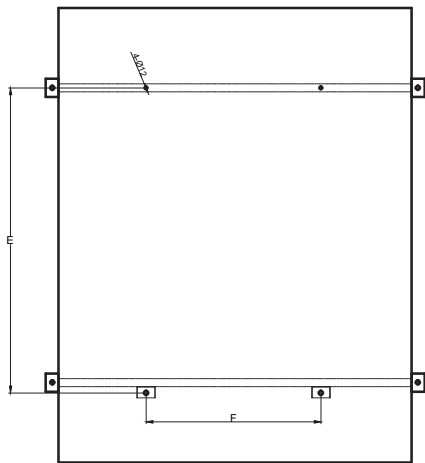
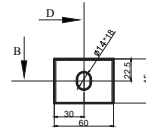
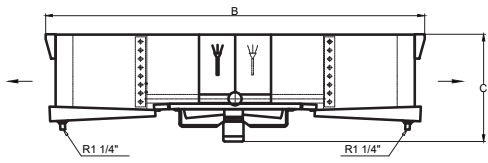

AED/D PLUS
4001/4501/5001/6301/8001

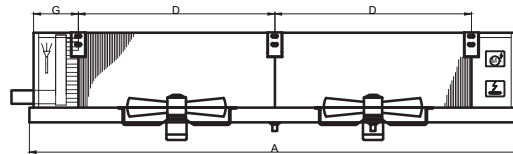

AED/D PLUS
4002/4502/5002/6302/8002

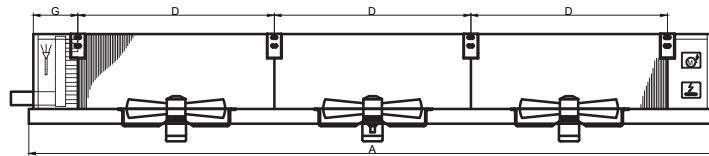

AED/D PLUS
4003/4503/5003/6303/8003

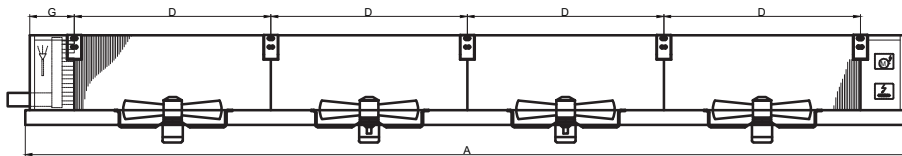

AED/D PLUS
4004/4504/5004/6304

AED & AED Plus SERIES EVAPORATOR

蒸发器系列 AED & AED Plus

Model / 型号	Dimensions / 尺寸 (mm)						
	A	B	C	D	E	F	G
AED Plus 4001...	1000	1390	415	600	655	565	190
AED Plus 4002...	1640	1390	415	600	1255	565	210
AED Plus 4003...	2280	1390	415	600	1855	565	230
AED Plus 4004...	2880	1390	415	600	2455	565	230
AED Plus 4501...	1200	1390	430	800	855	565	190
AED Plus 4502...	2040	1390	430	800	1655	565	210
AED Plus 4503...	2880	1390	430	800	2455	565	230
AED Plus 4504...	3680	1390	430	800	3255	565	230
AED Plus 5001...	1480	1530	430	1000	1055	565	230
AED Plus 5002...	2480	1530	430	1000	2055	565	230
AED Plus 5003...	3520	1530	430	1000	3055	565	250
AED Plus 5004...	4520	1530	430	1000	4055	565	250
AED Plus 6301...	1850	1705	570	1200	1255	745	315
AED Plus 6302...	3050	1705	570	1200	2455	745	315
AED Plus 6303...	4350	1705	570	1200	3655	745	365
AED Plus 6304...	5550	1705	570	1200	4855	745	365
AED Plus 8001...	2050	2020	750	1400	1455	1060	315
AED Plus 8002...	3450	2020	750	1400	2855	1060	315
AED Plus 8003...	4850	2020	750	1400	4255	1060	315

EVAPORATORS / 蒸发器 HFC/HFO(A2L)

双出风蒸发器

FIN SPACING 4.5 mm, with electrical defrost. Rt>=0°C

片距4.5mm, 带电加热。库温>=0°C

Model / 型号	Capacity / 制冷量 R454C (kW)		Capacity / 制冷量 R1234yf (kW)		Surface/ 面积 (m ²)	Tube Volume/ 管容积 (dm ³)	N.W/ 净重 (kg)	Connection/ 接口尺寸 (ø mm)	
	t _e = 0°C	t _e = -8°C	t _e = 0°C	t _e = -8°C				Inlet/ 进口	Outlet/ 出口
	DT1=10K	DT1=8K	DT1=10K	DT1=8K					
AED 2501 04 4.5D	1.82	1.17	1.68	1.10	3.6	1.0	10	12	12
AED 2502 08 4.5D	4.04	2.66	3.73	2.46	8.2	2.2	18	12	12
AED 2503 12 4.5D	6.25	4.12	5.77	3.81	12.8	3.4	26	12	19
AED 2504 16 4.5D	8.45	5.57	7.82	5.17	17.4	4.6	34	12	22

Model/ 型号	Axial Fans/ 轴流风机							Electric Defrost/ 电化霜	
	Diameter 直径 (Φ mm)	N°	Voltage/ 电压 (V, 50Hz)	Power/ 功率 (W)	Current/ 电流 (A)	Air Flow/ 风量 (m ³ /h)	Air Throw/ 射程 (m)	Coil/ 内芯 (W)	Total/ 总功率 (W)
AED 2501 04 4.5D	250	1	1 ~ 230	50	0.2	738	2 × 2	2 × 180	360
AED 2502 08 4.5D	250	2	1 ~ 230	100	0.5	1577	2 × 2	2 × 350	700
AED 2503 12 4.5D	250	3	1 ~ 230	150	0.7	2407	2 × 3	2 × 520	1040
AED 2504 16 4.5D	250	4	1 ~ 230	200	0.9	3235	2 × 3	2 × 695	1390

AED & AED Plus SERIES EVAPORATOR

蒸发器系列 AED & AED Plus

FIN SPACING 4 mm, with electrical defrost. Rt>=0°C

片距4mm, 带电加热。库温>=0°C

Model / 型号	Capacity / 制冷量 R454C (kW)		Capacity / 制冷量 R1234yf (kW)		Surface/ 面积 (m ²)	Tube Volume/ 管容积 (dm ³)	N.W/ 净重 (kg)	Connection/ 接口尺寸 (ø mm)	
	t _e = 0°C	t _e = -8°C	t _e = 0°C	t _e = -8°C				Inlet/ 进口	Outlet/ 出口
	DT1=10K	DT1=8K	DT1=10K	DT1=8K					
AED 3501 16 4LD	3.93	2.67	3.38	2.28	17.0	2.9	30	12	22
AED 3501 16 4ND	5.14	3.49	4.13	2.77	17.0	2.9	30	12	22
AED 3502 31 4LD	7.92	5.37	6.95	4.69	34.1	5.7	50	12	22
AED 3502 31 4ND	10.39	7.06	8.57	5.76	34.1	5.7	50	12	22
AED 3503 47 4LD	11.91	8.08	10.53	7.11	51.2	8.6	70	12	28
AED 3503 47 4ND	15.65	10.63	13.02	8.75	51.2	8.6	70	12	28
AED 3504 62 4LD	15.90	10.78	14.10	9.53	68.3	11.5	89	15	28
AED 3504 62 4ND	20.90	14.20	17.48	11.75	68.3	11.5	89	15	28

Model/ 型号	Axial Fans/ 轴流风机							Electric Defrost/ 电化霜	
	Diameter 直径 (Φ mm)	N°	Voltage/ 电压 (V, 50Hz)	Power/ 功率 (W)	Current/ 电流 (A)	Air Flow/ 风量 (m ³ /h)	Air Throw/ 射程 (m)	Coil/ 内芯 (W)	Total/总 功率 (W)
AED 3501 16 4LD	350	1	1 ~ 230	94	0.4	1181	2 × 6	2 × 320	640
AED 3501 16 4ND	350	1	1 ~ 230	150	0.7	1853	2 × 9	2 × 320	640
AED 3502 31 4LD	350	2	1 ~ 230	188	0.9	2365	2 × 7	2 × 585	1170
AED 3502 31 4ND	350	2	1 ~ 230	300	1.5	3705	2 × 10	2 × 585	1170
AED 3503 47 4LD	350	3	1 ~ 230	282	1.3	3549	2 × 8	2 × 850	1700
AED 3503 47 4ND	350	3	1 ~ 230	450	2.2	5558	2 × 11	2 × 850	1700
AED 3504 62 4LD	350	4	1 ~ 230	376	1.7	4732	2 × 9	2 × 1050	2100
AED 3504 62 4ND	350	4	1 ~ 230	600	2.9	7411	2 × 12	2 × 1050	2100

FIN SPACING 6 mm, with electrical defrost. Rt>=-18°C

片距6mm, 带电化霜库温>=-18°C

Model / 型号	Capacity / 制冷量 R454C (kW)		Capacity / 制冷量 R1234yf (kW)		Surface/ 面积 (m ²)	Tube Volume/ 管容积 (dm ³)	N.W/ 净重 (kg)	Connection/ 接口尺寸 (ø mm)	
	t _e = -8°C	t _e = -25°C	t _e = -8°C	t _e = -25°C				Inlet/ 进口	Outlet/ 出口
	DT1=8K	DT1=7K	DT1=8K	DT1=7K					
AED 3501 11 6LD	2.42	1.68	2.12	1.33	11.7	2.9	29	12	22
AED 3501 11 6ND	3.05	2.16	2.53	1.76	11.7	2.9	29	12	22
AED 3502 22 6LD	4.87	3.40	4.35	2.79	23.5	5.7	48	12	22
AED 3502 22 6ND	6.15	4.37	5.23	3.28	23.5	5.7	48	12	22
AED 3503 32 6LD	7.33	5.11	6.58	4.25	35.2	8.6	68	15	28
AED 3503 32 6ND	9.26	6.59	7.94	5.01	35.2	8.6	68	15	28
AED 3504 43 6LD	9.78	6.82	8.81	5.71	47.0	11.5	87	15	28
AED 3504 43 6ND	12.36	8.80	10.65	6.74	47.0	11.5	87	15	28

Model/ 型号	Axial Fans/ 轴流风机							Electric Defrost/ 电化霜	
	Diameter 直径 (Φ mm)	N°	Voltage/ 电压 (V, 50Hz)	Power/ 功率 (W)	Current/ 电流 (A)	Air Flow/ 风量 (m ³ /h)	Air Throw/ 射程 (m)	Coil/ 内芯 (W)	Total/ 总功率 (W)
AED 3501 11 6LD	350	1	1 ~ 230	94	0.4	1276	2 × 6	2 × 320	640
AED 3501 11 6ND	350	1	1 ~ 230	150	0.7	1883	2 × 9	2 × 320	640
AED 3502 22 6LD	350	2	1 ~ 230	188	0.9	2554	2 × 7	2 × 585	1170
AED 3502 22 6ND	350	2	1 ~ 230	300	1.5	3766	2 × 10	2 × 585	1170
AED 3503 32 6LD	350	3	1 ~ 230	282	1.3	3832	2 × 8	2 × 850	1700
AED 3503 32 6ND	350	3	1 ~ 230	450	2.2	5650	2 × 11	2 × 850	1700
AED 3504 43 6LD	350	4	1 ~ 230	376	1.7	5110	2 × 9	2 × 1050	2100
AED 3504 43 6ND	350	4	1 ~ 230	600	2.9	7533	2 × 12	2 × 1050	2100

AED & AED Plus SERIES EVAPORATOR

蒸发器系列 AED & AED Plus

FIN SPACING 4 mm, with electrical defrost. Rt>=0°C

片距4mm, 带电加热。库温>=0°C

Model / 型号	Capacity / 制冷量 R454C (kW)		Capacity / 制冷量 R1234yf (kW)		Surface/ 面积 (m ²)	Tube Volume/ 管容积 (dm ³)	N.W/ 净重 (kg)	Connection/ 接口尺寸 (ø mm)	
	t _e = 0°C	t _e = -8°C	t _e = 0°C	t _e = -8°C				Inlet/ 进口	Outlet/ 出口
	DT1=10K	DT1=8K	DT1=10K	DT1=8K					
AED 4001 36 4D	6.83	4.65	6.13	4.16	34.8	4.5	79	12	22
AED 4002 72 4D	13.73	9.34	12.50	8.50	69.6	9.0	127	15	35
AED 4003 108 4D	20.62	14.03	18.88	12.84	104.4	13.5	168	22	54
AED 4501 48 4D	9.65	6.59	7.78	5.26	46.4	6.0	88	15	22
AED 4502 96 4D	18.81	12.79	17.55	11.95	92.8	12.0	146	15	42
AED 4503 144 4D	28.67	19.50	26.16	17.78	139.2	18.0	200	22	54
AED 5001 90 4D	17.62	12.01	14.80	10.00	87.0	11.2	126	15	35
AED 5002 180 4D	34.03	22.64	32.23	21.94	174.1	22.5	215	22	54
AED 5003 270 4D	53.25	36.27	45.64	30.89	261.1	33.7	295	28	67
AED 6301 144 4D	28.21	19.22	23.16	15.63	139.2	18.0	191	22	54
AED 6302 288 4D	56.73	38.66	47.23	31.89	278.5	36.0	334	28	67
AED 6303 432 4D	85.11	58.11	67.67	45.60	417.7	54.0	497	35	76

Model/ 型号	Axial Fans/ 轴流风机							Electric Defrost/ 电化霜		
	Diameter 直径 (Φ mm)	N°	Voltage/ 电压 (V, 50Hz)	Power/ 功率 (W)	Current/ 电流 (A)	Air Flow/ 风量 (m ³ /h)	Air Throw/ 射程 (m)	Coil/ 内芯 (W)	Drain Pan/ 接水盘 (W)	Total/ 总 功率 (W)
AED 4001 36 4D	400	1	1 ~ 230	177	0.3	3169	2 × 5	4 × 340	2 × 340	2040
AED 4002 72 4D	400	2	1 ~ 230	354	0.6	6337	2 × 7	4 × 550	2 × 550	3300
AED 4003 108 4D	400	3	1 ~ 230	531	0.9	9506	2 × 8	4 × 800	2 × 800	4800
AED 4501 48 4D	450	1	3 ~ 400	350	1.1	4623	2 × 7	4 × 430	2 × 430	2580
AED 4502 96 4D	450	2	3 ~ 400	700	2.2	9256	2 × 9	4 × 780	2 × 780	4680
AED 4503 144 4D	450	3	3 ~ 400	1050	3.3	13878	2 × 11	4 × 1070	2 × 1070	6420
AED 5001 90 4D	500	1	3 ~ 400	577	1.4	6629	2 × 9	4 × 460	4 × 460	3680
AED 5002 180 4D	500	2	3 ~ 400	1154	2.8	13271	2 × 10	4 × 910	4 × 910	7280
AED 5003 270 4D	500	3	3 ~ 400	1731	4.1	19885	2 × 13	4 × 1350	4 × 1350	10800
AED 6301 144 4D	630	1	3 ~ 400	1118	2.3	9402	2 × 9	6 × 550	4 × 550	5500
AED 6302 288 4D	630	2	3 ~ 400	2236	4.5	18803	2 × 11	6 × 1070	4 × 1070	10700
AED 6303 432 4D	630	3	3 ~ 400	3354	6.8	28194	2 × 13	6 × 1590	4 × 1590	15900

FIN SPACING 7 mm, with electrical defrost. Rt>=-20°C

片距7mm, 带电加热。库温>=-20°C

Model / 型号	Capacity / 制冷量 R454C (kW)		Capacity / 制冷量 R1234yf (kW)		Surface/ 面积 (m ²)	Tube Volume/ 管容积 (dm ³)	N.W/ 净重 (kg)	Connection/ 接口尺寸 (ø mm)	
	t _e = -8°C	t _e = -25°C	t _e = -8°C	t _e = -25°C				Inlet/ 进口	Outlet/ 出口
	DT1=8K	DT1=7K	DT1=8K	DT1=7K					
AED 4001 31 7D	5.04	3.82	4.21	3.05	30.7	6.7	82	15	22
AED 4002 62 7D	10.17	7.74	8.69	5.87	61.4	13.5	132	15	35
AED 4003 93 7D	15.29	11.66	13.18	10.17	92.1	20.2	176	22	54
AED 4501 41 7D	6.96	5.03	6.35	4.75	40.9	9.0	92	15	35
AED 4502 82 7D	14.00	10.77	12.45	9.70	81.9	18.0	154	22	42
AED 4503 123 7D	19.12	15.25	19.31	14.65	122.8	27.0	211	22	54
AED 5001 51 7D	9.63	7.57	8.48	5.86	51.2	11.2	117	15	35
AED 5002 103 7D	16.32	13.64	17.53	13.86	102.4	22.5	198	22	54
AED 5003 155 7D	29.02	22.92	26.01	18.32	153.6	33.7	270	28	67
AED 6301 82 7D	16.08	12.65	14.44	10.85	81.9	18.0	177	22	54
*AED 6301 103 7D	19.72	15.27	18.21	12.65	109.2	24.0	189	22	54
AED 6302 165 7D	32.29	25.47	29.89	21.67	163.8	36.0	307	28	67
*AED 6302 206 7D	39.58	30.74	36.78	26.01	218.4	48.0	331	28	67
AED 6303 247 7D	48.98	37.90	43.82	33.28	245.7	54.0	456	35	76
*AED 6303 309 7D	59.87	43.62	53.09	36.65	327.6	72.0	492	35	76

Model / 型号	Axial Fans / 轴流风机							Electric Defrost / 电化霜		
	Diameter 直径 (Φ mm)	N°	Voltage / 电压 (V, 50Hz)	Power / 功率 (W)	Current / 电流 (A)	Air Flow / 风量 (m ³ /h)	Air Throw / 射程 (m)	Coil / 内芯 (W)	Drain Pan / 接水盘 (W)	Total / 总功率 (W)
AED 4001 31 7D	400	1	1 ~ 230	177	0.3	3123	2 × 6	4 × 340	4 × 340	2720
AED 4002 62 7D	400	2	1 ~ 230	354	0.6	6245	2 × 7	4 × 550	4 × 550	4400
AED 4003 93 7D	400	3	1 ~ 230	531	0.9	9368	2 × 8	4 × 800	4 × 800	6400
AED 4501 41 7D	450	1	3 ~ 400	350	1.1	4519	2 × 8	4 × 430	4 × 430	3440
AED 4502 82 7D	450	2	3 ~ 400	700	2.2	9045	2 × 9	4 × 780	4 × 780	6240
AED 4503 123 7D	450	3	3 ~ 400	1050	3.3	13579	2 × 11	4 × 1070	4 × 1070	8560
AED 5001 51 7D	500	1	3 ~ 400	577	1.4	7074	2 × 9	4 × 460	4 × 460	3680
AED 5002 103 7D	500	2	3 ~ 400	1154	2.8	14167	2 × 11	4 × 910	4 × 910	7280
AED 5003 155 7D	500	3	3 ~ 400	1731	4.1	21220	2 × 13	4 × 1350	4 × 1350	10800
AED 6301 82 7D	630	1	3 ~ 400	1118	2.3	10395	2 × 10	6 × 550	4 × 550	5500
*AED 6301 103 7D	630	1	3 ~ 400	1118	2.3	11634	2 × 9	8 × 550	4 × 550	6600
AED 6302 165 7D	630	2	3 ~ 400	2236	4.5	20790	2 × 12	6 × 1070	4 × 1070	10700
*AED 6302 206 7D	630	2	3 ~ 400	2236	4.5	23266	2 × 11	8 × 1070	4 × 1070	12840
AED 6303 247 7D	630	3	3 ~ 400	3354	6.8	31171	2 × 14	6 × 1590	4 × 1590	15900
*AED 6303 309 7D	630	3	3 ~ 400	3354	6.8	34870	2 × 13	8 × 1590	4 × 1590	19080

AED & AED Plus SERIES EVAPORATOR

蒸发器系列 AED & AED Plus

FIN SPACING 10 mm, with electrical defrost. Rt>=-35°C

片距10mm, 带电加热。库温>=-35°。

Model / 型号	Capacity / 制冷量 R454C (kW)		Capacity / 制冷量 R1234yf (kW)		Surface/ 面积 (m ²)	Tube Volume/ 管容积 (dm ³)	N.W/ 净重 (kg)	Connection/ 接口尺寸 (ø mm)	
	t _e = -8°C	t _e = -25°C	t _e = -8°C	t _e = -25°C				Inlet/ 进口	Outlet/ 出口
	DT1=8K	DT1=7K	DT1=8K	DT1=7K					
AED 4001 22 10D	4.93	3.75	3.67	2.49	22.1	6.7	80	15	22
AED 4002 43 10D	8.43	6.38	7.52	5.20	44.2	13.5	129	15	35
AED 4003 65 10D	12.67	9.60	11.38	7.91	66.3	20.2	171	22	54
AED 4501 29 10D	5.91	4.37	5.26	3.73	29.5	9.0	89	15	35
AED 4502 58 10D	11.45	8.84	10.69	7.68	59.0	18.0	149	22	42
AED 4503 86 10D	14.99	12.30	16.10	12.36	88.4	27.0	204	22	54
AED 5001 36 10D	7.84	6.14	7.25	5.26	36.8	11.2	114	15	35
AED 5002 72 10D	12.53	10.79	13.95	11.34	73.7	22.5	192	22	54
AED 5003 108 10D	23.62	18.52	22.12	16.27	110.5	33.7	261	28	67
AED 6301 58 10D	13.53	10.64	12.31	9.54	59.0	18.0	172	22	54
*AED 6301 72 10D	16.58	12.74	15.00	10.65	78.6	24.0	184	22	54
AED 6302 115 10D	27.14	21.39	24.44	17.28	117.9	36.0	298	28	67
*AED 6302 144 10D	33.23	25.60	30.36	21.75	157.2	48.0	320	28	67
AED 6303 173 10D	41.35	32.57	35.90	26.20	176.9	54.0	442	35	76
*AED 6303 216 10D	51.27	38.23	45.16	32.88	235.8	72.0	475	35	76

Model / 型号	Axial Fans / 轴流风机							Electric Defrost / 电化霜		
	Diameter 直径 (Φ mm)	N°	Voltage / 电压 (V, 50Hz)	Power / 功率 (W)	Current / 功率 (A)	Air Flow / 风量 (m ³ /h)	Air Throw / 射程 (m)	Coil / 内芯 (W)	Drain Pan / 接水盘 (W)	Total / 总功率 (W)
AED 4001 22 10D	400	1	1 ~ 230	177	0.3	3201	2 × 6	4 × 340	4 × 340	2720
AED 4002 43 10D	400	2	1 ~ 230	354	0.6	6401	2 × 7	4 × 550	4 × 550	4400
AED 4003 65 10D	400	3	1 ~ 230	531	0.9	9601	2 × 8	4 × 800	4 × 800	6400
AED 4501 29 10D	450	1	3 ~ 400	350	1.1	4698	2 × 8	4 × 430	4 × 430	3440
AED 4502 58 10D	450	2	3 ~ 400	700	2.2	9403	2 × 9	4 × 780	4 × 780	6240
AED 4503 86 10D	450	3	3 ~ 400	1050	3.3	14116	2 × 11	4 × 1070	4 × 1070	8560
AED 5001 36 10D	500	1	3 ~ 400	577	1.4	7319	2 × 8	4 × 460	4 × 460	3680
AED 5002 72 10D	500	2	3 ~ 400	1154	2.8	14662	2 × 10	4 × 910	4 × 910	7280
AED 5003 108 10D	500	3	3 ~ 400	1731	4.1	21955	2 × 12	4 × 1350	4 × 1350	10800
AED 6301 58 10D	630	1	3 ~ 400	1118	2.3	10916	2 × 11	6 × 550	4 × 550	5500
*AED 6301 72 10D	630	1	3 ~ 400	1118	2.3	12083	2 × 10	8 × 550	4 × 550	6600
AED 6302 115 10D	630	2	3 ~ 400	2236	4.5	21832	2 × 13	6 × 1070	4 × 1070	10700
*AED 6302 144 10D	630	2	3 ~ 400	2236	4.5	24165	2 × 12	8 × 1070	4 × 1070	12840
AED 6303 173 10D	630	3	3 ~ 400	3354	6.8	32731	2 × 15	6 × 1590	4 × 1590	15900
*AED 6303 216 10D	630	3	3 ~ 400	3354	6.8	36212	2 × 14	8 × 1590	4 × 1590	19080

DUAL DISCHARGE CEILING AIR TYPE EVAPORATORS

HFC/HFO(A2L)

双出风蒸发器

FIN SPACING 4 mm, with electrical defrost. Rt>=0°C

片距4mm, 带电加热。库温>=0°C

Model / 型号	Capacity / 制冷量 R454C (kW)		Capacity / 制冷量 R1234yf (kW)		Surface/ 面积 (m ²)	Tube Volume/ 管容积 (dm ³)	N.W/ 净重 (kg)	Connection/ 接口尺寸 (ø mm)	
	t _e = 0°C	t _e = -8°C	t _e = 0°C	t _e = -8°C				Inlet/ 进口	Outlet/ 出口
	DT1=10K	DT1=8K	DT1=10K	DT1=8K					
AED Plus 4001 23 4D	8.01	5.44	7.20	4.87	22.8	3.8	69	12	28
AED Plus 4001 34 4D	10.06	6.80	9.26	6.28	34.2	5.8	77	12	28
AED Plus 4002 46 4D	16.10	10.93	14.69	9.95	45.6	7.7	116	15	35
AED Plus 4002 68 4D	21.33	14.61	17.42	11.76	68.4	11.5	129	22	35
AED Plus 4003 68 4D	18.23	12.47	15.69	10.63	68.4	11.5	154	22	35
AED Plus 4003 103 4D	32.19	21.89	29.15	19.77	102.6	17.3	175	22	54
AED Plus 4004 91 4D	32.28	21.90	29.68	20.11	91.2	15.3	200	28	54
AED Plus 4004 137 4D	40.74	27.90	34.19	23.13	136.8	23.0	225	28	54
AED Plus 4501 30 4D	11.20	7.67	9.09	6.13	30.4	5.1	79	12	28
AED Plus 4501 46 4D	14.15	9.67	11.97	8.09	45.6	7.7	89	15	28
AED Plus 4502 61 4D	22.59	15.46	18.71	12.64	60.8	10.2	134	22	35
AED Plus 4502 91 4D	28.47	19.45	24.50	16.59	91.2	15.3	152	22	42
AED Plus 4503 91 4D	33.74	22.90	30.83	20.89	91.2	15.3	181	28	54
AED Plus 4503 137 4D	42.62	29.19	35.36	23.90	136.8	23.0	206	28	54
AED Plus 4504 122 4D	45.36	31.04	37.99	25.67	121.6	20.5	235	28	54
AED Plus 4504 182 4D	57.11	39.03	49.61	33.60	182.4	30.7	271	35	67
AED Plus 5001 57 4D	13.71	8.25	13.58	9.06	57.0	9.6	114	22	42
AED Plus 5001 76 4D	18.27	11.32	17.97	12.05	76.0	12.8	126	22	54
AED Plus 5002 114 4D	39.94	26.77	37.88	25.64	114.0	19.2	196	28	67
AED Plus 5002 152 4D	45.26	29.67	43.45	29.57	152.0	25.6	219	28	67
AED Plus 5003 171 4D	61.39	41.92	52.90	35.80	171.0	28.8	265	28	67
AED Plus 5003 228 4D	69.55	47.42	61.76	41.87	228.0	38.4	298	35	67
AED Plus 5004 228 4D	79.95	53.59	76.07	51.51	228.0	38.4	349	2 × 28	2 × 54
AED Plus 5004 304 4D	90.57	59.38	87.19	59.34	303.9	51.2	395	2 × 28	2 × 67
AED Plus 6301 103 4D	36.81	24.97	33.42	22.62	102.6	17.3	172	28	54
AED Plus 6301 137 4D	41.56	28.23	38.72	27.09	136.8	23.0	193	28	67
AED Plus 6302 205 4D	68.90	46.03	62.23	42.14	205.2	34.5	299	35	67
AED Plus 6302 274 4D	79.12	54.32	73.56	52.48	273.6	46.0	338	35	67
AED Plus 6303 308 4D	110.82	75.98	88.84	59.94	307.7	51.8	410	2 × 28	2 × 54
AED Plus 6303 410 4D	127.09	87.02	105.81	71.56	410.3	69.1	474	2 × 28	2 × 54
AED Plus 6304 410 4D	147.79	100.27	135.85	92.05	410.3	69.1	547	2 × 35	2 × 67
AED Plus 6304 547 4D	168.67	114.67	157.81	107.08	547.1	92.1	627	2 × 35	2 × 76
AED Plus 8001 160 4D	51.37	34.96	45.72	30.97	159.6	26.9	248	28	67
AED Plus 8001 213 4D	58.02	39.60	52.91	35.94	212.8	35.8	310	28	67
AED Plus 8002 319 4D	103.01	70.12	92.46	62.67	319.1	53.7	432	2 × 28	2 × 54
AED Plus 8002 426 4D	116.28	79.35	106.79	72.56	425.5	71.6	492	2 × 28	2 × 67
AED Plus 8003 479 4D	152.04	104.44	117.73	79.30	478.7	80.6	593	2 × 28	2 × 54
AED Plus 8003 638 4D	172.81	118.66	139.92	94.61	638.3	107.4	680	2 × 35	2 × 67

AED & AED Plus SERIES EVAPORATOR

蒸发器系列 AED & AED Plus

FIN SPACING 4 mm, with electrical defrost. Rt>=0°C

片距4mm, 带电加热。库温>=0°C

Model/ 型号	Axial Fans/ 轴流风机							Electric Defrost/ 电化霜		
	Diameter 直径 (Φ mm)	N°	Voltage/ 电压 (V, 50Hz)	Power/ 功率 (W)	Current/ 电流 (A)	Air Flow/ 风量 (m3/h)	Air Throw/ 射程 (m)	Coil/ 内芯 (W)	Drain Pan/ 接水盘 (W)	Total/ 总 功率 (W)
AED Plus 4001 23 4D	400	1	1 ~ 230	177	0.3	3095	2 × 5	4 × 320	2 × 320	1920
AED Plus 4001 34 4D	400	1	1 ~ 230	177	0.3	2850	2 × 5	4 × 320	4 × 320	2560
AED Plus 4002 46 4D	400	2	1 ~ 230	354	0.6	6190	2 × 6	4 × 585	2 × 585	3510
AED Plus 4002 68 4D	400	2	1 ~ 230	354	0.6	5698	2 × 6	4 × 585	4 × 585	4680
AED Plus 4003 68 4D	400	3	1 ~ 230	531	0.9	9282	2 × 8	4 × 800	2 × 800	4800
AED Plus 4003 103 4D	400	3	1 ~ 230	531	0.9	8549	2 × 7	4 × 800	4 × 800	6400
AED Plus 4004 91 4D	400	4	1 ~ 230	708	1.2	12380	2 × 9	4 × 1070	2 × 1070	6420
AED Plus 4004 137 4D	400	4	1 ~ 230	708	1.2	11396	2 × 8	4 × 1070	4 × 1070	8560
AED Plus 4501 30 4D	450	1	3 ~ 400	350	1.1	4463	2 × 7	4 × 420	2 × 420	2520
AED Plus 4501 46 4D	450	1	3 ~ 400	350	1.1	4083	2 × 6	4 × 420	4 × 420	3360
AED Plus 4502 61 4D	450	2	3 ~ 400	700	2.2	8926	2 × 8	4 × 780	2 × 780	4680
AED Plus 4502 91 4D	450	2	3 ~ 400	700	2.2	8165	2 × 7	4 × 780	4 × 780	6240
AED Plus 4503 91 4D	450	3	3 ~ 400	1050	3.3	13394	2 × 9	4 × 1070	2 × 1070	6420
AED Plus 4503 137 4D	450	3	3 ~ 400	1050	3.3	12246	2 × 9	4 × 1070	4 × 1070	8560
AED Plus 4504 122 4D	450	4	3 ~ 400	1400	4.4	17851	2 × 11	4 × 1460	2 × 1460	8760
AED Plus 4504 182 4D	450	4	3 ~ 400	1400	4.4	16330	2 × 10	4 × 1460	4 × 1460	11680
AED Plus 5001 57 4D	500	1	3 ~ 400	577	1.4	6375	2 × 8	4 × 460	4 × 460	3680
AED Plus 5001 76 4D	500	1	3 ~ 400	577	1.4	5909	2 × 8	6 × 460	4 × 460	4600
AED Plus 5002 114 4D	500	2	3 ~ 400	1154	2.8	12750	2 × 10	4 × 910	4 × 910	7280
AED Plus 5002 152 4D	500	2	3 ~ 400	1154	2.8	11818	2 × 9	6 × 910	4 × 910	9100
AED Plus 5003 171 4D	500	3	3 ~ 400	1731	4.1	19113	2 × 12	4 × 1350	4 × 1350	10800
AED Plus 5003 228 4D	500	3	3 ~ 400	1731	4.1	17718	2 × 11	6 × 1350	4 × 1350	13500
AED Plus 5004 228 4D	500	4	3 ~ 400	2308	5.5	25499	2 × 14	4 × 1760	4 × 1760	14080
AED Plus 5004 304 4D	500	4	3 ~ 400	2308	5.5	23635	2 × 13	6 × 1760	4 × 1760	17600
AED Plus 6301 103 4D	630	1	3 ~ 400	1118	2.3	11661	2 × 10	6 × 585	4 × 585	5850
AED Plus 6301 137 4D	630	1	3 ~ 400	1118	2.3	10926	2 × 10	8 × 585	4 × 585	7020
AED Plus 6302 205 4D	630	2	3 ~ 400	2236	4.5	23311	2 × 13	6 × 1070	4 × 1070	10700
AED Plus 6302 274 4D	630	2	3 ~ 400	2236	4.5	21845	2 × 12	8 × 1070	4 × 1070	12840
AED Plus 6303 308 4D	630	3	3 ~ 400	3354	6.8	34966	2 × 15	6 × 1590	4 × 1590	15900
AED Plus 6303 410 4D	630	3	3 ~ 400	3354	6.8	32767	2 × 14	8 × 1590	4 × 1590	19080
AED Plus 6304 410 4D	630	4	3 ~ 400	4472	9.0	46642	2 × 18	6 × 2090	4 × 2090	20900
AED Plus 6304 547 4D	630	4	3 ~ 400	4472	9.0	43703	2 × 17	8 × 2090	4 × 2090	25080
AED Plus 8001 160 4D	800	1	3 ~ 400	1369	3.4	15034	2 × 11	8 × 640	4 × 640	7680
AED Plus 8001 213 4D	800	1	3 ~ 400	1369	3.4	14134	2 × 10	10 × 640	4 × 640	8960
AED Plus 8002 319 4D	800	2	3 ~ 400	2738	6.7	30066	2 × 13	8 × 1240	4 × 1240	14880
AED Plus 8002 426 4D	800	2	3 ~ 400	2738	6.7	28267	2 × 12	10 × 1240	4 × 1240	17360
AED Plus 8003 479 4D	800	3	3 ~ 400	4107	10.1	45088	2 × 16	8 × 1830	4 × 1830	21960
AED Plus 8003 638 4D	800	3	3 ~ 400	4107	10.1	42391	2 × 15	10 × 1830	4 × 1830	25620

EVAPORATORS/ 蒸发器 HFC/HFO(A2L)

DUAL DISCHARGE CEILING AIR TYPE EVAPORATORS

HFC/HFO(A2L)

双出风蒸发器

FIN SPACING 6 mm, with electrical defrost. Rt>=-18°C

片距6mm, 带电化霜库温>=-18°C

Model / 型号	Capacity / 制冷量 R454C (kW)		Capacity / 制冷量 R1234yf (kW)		Surface/ 面积 (m ²)	Tube Volume/ 管容积 (dm ³)	N.W/ 净重 (kg)	Connection/ 接口尺寸 (ø mm)	
	t _e = -8°C	t _e = -25°C	t _e = -8°C	t _e = -25°C				Inlet/ 进口	Outlet/ 出口
	DT1=8K	DT1=7K	DT1=8K	DT1=7K					
AED Plus 4001 16 6D	4.55	3.31	4.22	2.89	15.7	3.8	69	12	28
AED Plus 4001 24 6D	5.87	4.27	5.66	3.83	23.5	5.8	75	12	28
AED Plus 4002 31 6D	9.14	6.65	8.58	5.94	31.4	7.7	114	15	35
AED Plus 4002 47 6D	12.35	8.75	10.46	6.53	47.0	11.5	126	22	35
AED Plus 4003 47 6D	14.13	10.09	12.86	9.02	47.0	11.5	151	22	35
AED Plus 4003 71 6D	18.26	13.07	17.02	11.53	70.6	17.3	171	22	54
AED Plus 4004 63 6D	18.31	13.34	17.31	12.06	62.7	15.3	196	28	54
AED Plus 4004 94 6D	24.81	17.62	21.28	13.41	94.1	23.0	220	28	54
AED Plus 4501 21 6D	6.56	4.74	5.51	3.49	20.9	5.1	78	12	28
AED Plus 4501 31 6D	8.56	6.11	7.41	4.72	31.4	7.7	87	15	28
AED Plus 4502 42 6D	13.20	9.57	11.29	7.21	41.8	10.2	132	22	35
AED Plus 4502 63 6D	17.20	12.32	15.14	9.77	62.7	15.3	148	22	42
AED Plus 4503 63 6D	19.39	14.17	18.13	12.61	62.7	15.3	177	28	54
AED Plus 4503 94 6D	26.39	18.79	22.29	13.95	94.1	23.0	201	28	54
AED Plus 4504 84 6D	27.04	19.65	23.24	14.92	83.6	20.5	231	28	54
AED Plus 4504 125 6D	35.10	25.21	31.04	20.13	125.4	30.7	264	35	67
AED Plus 5001 39 6D	11.32	8.46	11.29	8.01	39.2	9.6	112	22	42
AED Plus 5001 52 6D	13.04	9.73	13.33	9.38	52.3	12.8	123	22	54
AED Plus 5002 78 6D	22.67	16.96	22.72	16.33	78.4	19.2	192	28	67
AED Plus 5002 105 6D	26.11	19.50	26.81	18.98	104.5	25.6	213	28	67
AED Plus 5003 118 6D	36.86	26.85	32.49	21.24	117.6	28.8	258	28	67
AED Plus 5003 157 6D	43.07	30.85	38.85	25.56	156.8	38.4	289	35	67
AED Plus 5004 157 6D	45.37	33.96	45.60	32.89	156.8	38.4	340	2 × 28	2 × 54
AED Plus 5004 209 6D	52.25	39.04	53.78	38.18	209.1	51.2	383	2 × 28	2 × 67
AED Plus 6301 71 6D	21.76	15.83	20.15	13.86	70.6	17.3	168	28	54
AED Plus 6301 94 6D	25.27	18.32	24.23	16.59	94.1	23.0	188	28	67
AED Plus 6302 141 6D	44.55	31.89	36.48	25.14	141.1	34.5	292	35	67
AED Plus 6302 188 6D	52.60	37.43	44.36	27.68	188.2	46.0	328	35	67
AED Plus 6303 212 6D	66.96	47.98	55.12	31.78	211.7	51.8	398	2 × 28	2 × 54
AED Plus 6303 282 6D	79.03	56.30	66.97	41.94	282.2	69.1	458	2 × 28	2 × 54
AED Plus 6304 282 6D	87.28	63.61	81.74	56.83	282.2	69.1	531	2 × 35	2 × 67
AED Plus 6304 376 6D	101.34	73.57	98.02	67.79	376.3	92.1	606	2 × 35	2 × 76
AED Plus 8001 110 6D	30.51	21.94	27.77	18.51	109.8	26.9	242	28	67
AED Plus 8001 146 6D	35.64	25.34	33.15	22.19	146.3	35.8	302	28	67
AED Plus 8002 220 6D	61.15	44.02	56.08	37.64	219.5	53.7	420	2 × 28	2 × 54
AED Plus 8002 293 6D	71.41	50.83	66.85	45.02	292.7	71.6	476	2 × 28	2 × 67
AED Plus 8003 329 6D	92.47	65.32	73.54	50.05	329.3	80.6	574	2 × 28	2 × 54
AED Plus 8003 439 6D	108.85	76.94	89.49	53.85	439.0	107.4	655	2 × 35	2 × 67

AED & AED Plus SERIES EVAPORATOR

蒸发器系列 AED & AED Plus

FIN SPACING 6 mm, with electrical defrost. Rt>=-18°C

片距6mm, 带电化霜库温>=-18°C

Model/ 型号	Axial Fans/ 轴流风机							Electric Defrost/ 电化霜			
	Diameter 直径 (Φ mm)	N°	Voltage/ 电压 (V, 50Hz)	Power/ 功率 (W)	Current/ 电流 (A)	Air Flow/ 风量 (m3/h)	Air Throw/ 射程 (m)	Coil/ 内芯 (W)	Drain Pan/ 接水盘 (W)	Total/ 总 功率 (W)	
AED Plus 4001 16 6D	400	1	1 ~ 230	177	0.3	3186	2 × 6	4 × 320	2 × 320	1920	
AED Plus 4001 24 6D	400	1	1 ~ 230	177	0.3	2994	2 × 5	4 × 320	4 × 320	2560	
AED Plus 4002 31 6D	400	2	1 ~ 230	354	0.6	6371	2 × 7	4 × 585	2 × 585	3510	
AED Plus 4002 47 6D	400	2	1 ~ 230	354	0.6	5984	2 × 6	4 × 585	4 × 585	4680	
AED Plus 4003 47 6D	400	3	1 ~ 230	531	0.9	9553	2 × 8	4 × 800	2 × 800	4800	
AED Plus 4003 71 6D	400	3	1 ~ 230	531	0.9	8979	2 × 7	4 × 800	4 × 800	6400	
AED Plus 4004 63 6D	400	4	1 ~ 230	708	1.2	12742	2 × 9	4 × 1070	2 × 1070	6420	
AED Plus 4004 94 6D	400	4	1 ~ 230	708	1.2	11968	2 × 9	4 × 1070	4 × 1070	8560	
AED Plus 4501 21 6D	450	1	3 ~ 400	350	1.1	4662	2 × 7	4 × 420	2 × 420	2520	
AED Plus 4501 31 6D	450	1	3 ~ 400	350	1.1	4290	2 × 6	4 × 420	4 × 420	3360	
AED Plus 4502 42 6D	450	2	3 ~ 400	700	2.2	9323	2 × 8	4 × 780	2 × 780	4680	
AED Plus 4502 63 6D	450	2	3 ~ 400	700	2.2	8579	2 × 8	4 × 780	4 × 780	6240	
AED Plus 4503 63 6D	450	3	3 ~ 400	1050	3.3	13992	2 × 10	4 × 1070	2 × 1070	6420	
AED Plus 4503 94 6D	450	3	3 ~ 400	1050	3.3	12867	2 × 9	4 × 1070	4 × 1070	8560	
AED Plus 4504 84 6D	450	4	3 ~ 400	1400	4.4	18646	2 × 12	4 × 1460	2 × 1460	8760	
AED Plus 4504 125 6D	450	4	3 ~ 400	1400	4.4	17157	2 × 11	4 × 1460	4 × 1460	11680	
AED Plus 5001 39 6D	500	1	3 ~ 400	577	1.4	6702	2 × 9	4 × 460	4 × 460	3680	
AED Plus 5001 52 6D	500	1	3 ~ 400	577	1.4	6255	2 × 8	6 × 460	4 × 460	4600	
AED Plus 5002 78 6D	500	2	3 ~ 400	1154	2.8	13404	2 × 10	4 × 910	4 × 910	7280	
AED Plus 5002 105 6D	500	2	3 ~ 400	1154	2.8	12509	2 × 10	6 × 910	4 × 910	9100	
AED Plus 5003 118 6D	500	3	3 ~ 400	1731	4.1	20090	2 × 12	4 × 1350	4 × 1350	10800	
AED Plus 5003 157 6D	500	3	3 ~ 400	1731	4.1	18752	2 × 12	6 × 1350	4 × 1350	13500	
AED Plus 5004 157 6D	500	4	3 ~ 400	2308	5.5	26807	2 × 15	4 × 1760	4 × 1760	14080	
AED Plus 5004 209 6D	500	4	3 ~ 400	2308	5.5	25018	2 × 14	6 × 1760	4 × 1760	17600	
AED Plus 6301 71 6D	630	1	3 ~ 400	1118	2.3	12160	2 × 11	6 × 585	4 × 585	5850	
AED Plus 6301 94 6D	630	1	3 ~ 400	1118	2.3	11474	2 × 10	8 × 585	4 × 585	7020	
AED Plus 6302 141 6D	630	2	3 ~ 400	2236	4.5	24308	2 × 13	6 × 1070	4 × 1070	10700	
AED Plus 6302 188 6D	630	2	3 ~ 400	2236	4.5	22938	2 × 12	8 × 1070	4 × 1070	12840	
AED Plus 6303 212 6D	630	3	3 ~ 400	3354	6.8	36462	2 × 16	6 × 1590	4 × 1590	15900	
AED Plus 6303 282 6D	630	3	3 ~ 400	3354	6.8	34407	2 × 15	8 × 1590	4 × 1590	19080	
AED Plus 6304 282 6D	630	4	3 ~ 400	4472	9.0	48639	2 × 19	6 × 2090	4 × 2090	20900	
AED Plus 6304 376 6D	630	4	3 ~ 400	4472	9.0	45896	2 × 18	8 × 2090	4 × 2090	25080	
AED Plus 8001 110 6D	800	1	3 ~ 400	1369	3.4	15557	2 × 11	8 × 640	4 × 640	7680	
AED Plus 8001 146 6D	800	1	3 ~ 400	1369	3.4	14835	2 × 11	10 × 640	4 × 640	8960	
AED Plus 8002 220 6D	800	2	3 ~ 400	2738	6.7	31113	2 × 14	8 × 1240	4 × 1240	14880	
AED Plus 8002 293 6D	800	2	3 ~ 400	2738	6.7	29670	2 × 13	10 × 1240	4 × 1240	17360	
AED Plus 8003 329 6D	800	3	3 ~ 400	4107	10.1	46656	2 × 16	8 × 1830	4 × 1830	21960	
AED Plus 8003 439 6D	800	3	3 ~ 400	4107	10.1	44493	2 × 16	10 × 1830	4 × 1830	25620	

EVAPORATORS/ 蒸发器 HFC/HFO(A2L)

DUAL DISCHARGE CEILING AIR TYPE EVAPORATORS

HFC/HFO(A2L)

双出风蒸发器

FIN SPACING 9 mm, with electrical defrost. Rt>=-35°C

片距9mm, 带电化霜库温>=-35°。

Model / 型号	Capacity / 制冷量 R454C (kW)		Capacity / 制冷量 R1234yf (kW)		Surface/ 面积 (m ²)	Tube Volume/ 管容积 (dm ³)	N.W/ 净重 (kg)	Connection/ 接口尺寸 (ø mm)	
	t _e = -8°C	t _e = -25°C	t _e = -8°C	t _e = -25°C				Inlet/ 进口	Outlet/ 出口
	DT1=8K	DT1=7K	DT1=8K	DT1=7K					
AED Plus 4001 11 9D	3.55	2.61	3.51	2.41	10.9	3.8	67	12	28
AED Plus 4001 16 9D	4.79	3.52	4.81	3.30	16.4	5.8	74	12	28
AED Plus 4002 22 9D	7.11	5.23	7.11	4.94	21.9	7.7	112	15	35
AED Plus 4002 33 9D	10.42	7.34	9.20	5.90	32.8	11.5	123	22	35
AED Plus 4003 33 9D	11.48	8.18	10.05	6.43	32.8	11.5	148	22	35
AED Plus 4003 49 9D	14.92	10.80	14.64	9.98	49.2	17.3	166	22	54
AED Plus 4004 44 9D	14.25	10.49	14.29	9.99	43.7	15.3	192	28	54
AED Plus 4004 66 9D	20.90	14.76	18.66	12.06	65.6	23.0	213	28	54
AED Plus 4501 15 9D	5.34	3.83	4.72	3.06	14.6	5.1	76	12	28
AED Plus 4501 22 9D	7.24	5.11	6.50	4.24	21.9	7.7	85	15	28
AED Plus 4502 29 9D	10.72	7.70	9.62	6.32	29.2	10.2	129	22	35
AED Plus 4502 44 9D	14.53	10.29	13.21	8.73	43.7	15.3	144	22	42
AED Plus 4503 44 9D	15.19	11.17	15.06	10.54	43.7	15.3	173	28	54
AED Plus 4503 66 9D	21.91	15.54	19.39	12.48	65.6	23.0	194	28	54
AED Plus 4504 58 9D	21.49	15.46	19.42	12.84	58.3	20.5	225	28	54
AED Plus 4504 88 9D	29.11	20.64	26.65	17.71	87.5	30.7	255	35	67
AED Plus 5001 27 9D	9.13	6.91	9.52	6.78	27.3	9.6	109	22	42
AED Plus 5001 37 9D	10.91	8.24	11.40	8.16	36.5	12.8	120	22	54
AED Plus 5002 55 9D	18.27	13.83	19.13	13.71	54.7	19.2	186	28	67
AED Plus 5002 73 9D	21.83	16.51	22.91	16.47	72.9	25.6	206	28	67
AED Plus 5003 82 9D	30.90	22.26	28.23	18.88	82.0	28.8	250	28	67
AED Plus 5003 109 9D	37.27	26.52	34.50	23.17	109.4	38.4	279	35	67
AED Plus 5004 109 9D	36.57	27.69	38.37	27.58	109.4	38.4	330	2 × 28	2 × 54
AED Plus 5004 146 9D	43.68	33.03	45.94	33.09	145.8	51.2	369	2 × 28	2 × 67
AED Plus 6301 49 9D	17.23	12.74	15.43	12.12	49.2	17.3	163	28	54
AED Plus 6301 66 9D	21.05	15.96	19.47	14.45	65.6	23.0	181	28	67
AED Plus 6302 98 9D	35.11	24.27	31.07	20.61	98.4	34.5	282	35	67
AED Plus 6302 131 9D	42.26	29.23	39.06	28.51	131.2	46.0	315	35	67
AED Plus 6303 148 9D	51.39	35.53	50.63	33.56	147.6	51.8	384	2 × 28	2 × 54
AED Plus 6303 197 9D	64.91	44.61	63.77	41.86	196.8	69.1	439	2 × 28	2 × 54
AED Plus 6304 197 9D	70.34	51.67	69.45	48.85	196.8	69.1	512	2 × 35	2 × 67
AED Plus 6304 263 9D	84.78	62.26	85.15	59.40	262.5	92.1	580	2 × 35	2 × 76
AED Plus 8001 77 9D	25.09	18.04	23.95	16.20	76.6	26.9	234	28	67
AED Plus 8001 102 9D	30.06	21.62	29.24	19.70	102.1	35.8	292	28	67
AED Plus 8002 153 9D	50.26	36.16	48.23	32.83	153.1	53.7	405	2 × 28	2 × 54
AED Plus 8002 204 9D	60.20	43.32	58.85	39.89	204.1	71.6	456	2 × 28	2 × 67
AED Plus 8003 230 9D	78.03	55.31	65.47	42.68	229.7	80.6	552	2 × 28	2 × 54
AED Plus 8003 306 9D	94.47	66.71	81.04	50.50	306.2	107.4	625	2 × 35	2 × 67

AED & AED Plus SERIES EVAPORATOR

蒸发器系列 AED & AED Plus

FIN SPACING 9 mm, with electrical defrost. Rt>=-35°C

片距9mm, 带电化霜库温>=-35°。

Model/ 型号	Axial Fans/ 轴流风机							Electric Defrost/ 电化霜			
	Diameter 直径 (Φ mm)	N°	Voltage/ 电压 (V, 50Hz)	Power/ 功率 (W)	Current/ 电流 (A)	Air Flow/ 风量 (m3/h)	Air Throw/ 射程 (m)	Coil/ 内芯 (W)	Drain Pan/ 接水盘 (W)	Total/ 总 功率 (W)	
AED Plus 4001 11 9D	400	1	1 ~ 230	177	0.3	3266	2 × 6	4 × 320	2 × 320	1920	
AED Plus 4001 16 9D	400	1	1 ~ 230	177	0.3	3104	2 × 5	4 × 320	4 × 320	2560	
AED Plus 4002 22 9D	400	2	1 ~ 230	354	0.6	6531	2 × 7	4 × 585	2 × 585	3510	
AED Plus 4002 33 9D	400	2	1 ~ 230	354	0.6	6204	2 × 6	4 × 585	4 × 585	4680	
AED Plus 4003 33 9D	400	3	1 ~ 230	531	0.9	9792	2 × 8	4 × 800	2 × 800	4800	
AED Plus 4003 49 9D	400	3	1 ~ 230	531	0.9	9308	2 × 8	4 × 800	4 × 800	6400	
AED Plus 4004 44 9D	400	4	1 ~ 230	708	1.2	13061	2 × 10	4 × 1070	2 × 1070	6420	
AED Plus 4004 66 9D	400	4	1 ~ 230	708	1.2	12408	2 × 9	4 × 1070	4 × 1070	8560	
AED Plus 4501 15 9D	450	1	3 ~ 400	350	1.1	4815	2 × 7	4 × 420	2 × 420	2520	
AED Plus 4501 22 9D	450	1	3 ~ 400	350	1.1	4478	2 × 7	4 × 420	4 × 420	3360	
AED Plus 4502 29 9D	450	2	3 ~ 400	700	2.2	9629	2 × 8	4 × 780	2 × 780	4680	
AED Plus 4502 44 9D	450	2	3 ~ 400	700	2.2	8956	2 × 8	4 × 780	4 × 780	6240	
AED Plus 4503 44 9D	450	3	3 ~ 400	1050	3.3	14448	2 × 10	4 × 1070	2 × 1070	6420	
AED Plus 4503 66 9D	450	3	3 ~ 400	1050	3.3	13432	2 × 9	4 × 1070	4 × 1070	8560	
AED Plus 4504 58 9D	450	4	3 ~ 400	1400	4.4	19257	2 × 12	4 × 1460	2 × 1460	8760	
AED Plus 4504 88 9D	450	4	3 ~ 400	1400	4.4	17912	2 × 11	4 × 1460	4 × 1460	11680	
AED Plus 5001 27 9D	500	1	3 ~ 400	577	1.4	7007	2 × 9	4 × 460	4 × 460	3680	
AED Plus 5001 37 9D	500	1	3 ~ 400	577	1.4	6588	2 × 9	6 × 460	4 × 460	4600	
AED Plus 5002 55 9D	500	2	3 ~ 400	1154	2.8	14013	2 × 11	4 × 910	4 × 910	7280	
AED Plus 5002 73 9D	500	2	3 ~ 400	1154	2.8	13174	2 × 10	6 × 910	4 × 910	9100	
AED Plus 5003 82 9D	500	3	3 ~ 400	1731	4.1	21001	2 × 13	4 × 1350	4 × 1350	10800	
AED Plus 5003 109 9D	500	3	3 ~ 400	1731	4.1	19747	2 × 12	6 × 1350	4 × 1350	13500	
AED Plus 5004 109 9D	500	4	3 ~ 400	2308	5.5	28025	2 × 15	4 × 1760	4 × 1760	14080	
AED Plus 5004 146 9D	500	4	3 ~ 400	2308	5.5	26348	2 × 15	6 × 1760	4 × 1760	17600	
AED Plus 6301 49 9D	630	1	3 ~ 400	1118	2.3	12527	2 × 11	6 × 585	4 × 585	5850	
AED Plus 6301 66 9D	630	1	3 ~ 400	1118	2.3	11985	2 × 11	8 × 585	4 × 585	7020	
AED Plus 6302 98 9D	630	2	3 ~ 400	2236	4.5	25042	2 × 13	6 × 1070	4 × 1070	10700	
AED Plus 6302 131 9D	630	2	3 ~ 400	2236	4.5	23958	2 × 13	8 × 1070	4 × 1070	12840	
AED Plus 6303 148 9D	630	3	3 ~ 400	3354	6.8	37563	2 × 16	6 × 1590	4 × 1590	15900	
AED Plus 6303 197 9D	630	3	3 ~ 400	3354	6.8	35936	2 × 15	8 × 1590	4 × 1590	19080	
AED Plus 6304 197 9D	630	4	3 ~ 400	4472	9.0	50105	2 × 19	6 × 2090	4 × 2090	20900	
AED Plus 6304 263 9D	630	4	3 ~ 400	4472	9.0	47939	2 × 18	8 × 2090	4 × 2090	25080	
AED Plus 8001 77 9D	800	1	3 ~ 400	1369	3.4	16024	2 × 12	8 × 640	4 × 640	7680	
AED Plus 8001 102 9D	800	1	3 ~ 400	1369	3.4	15377	2 × 11	10 × 640	4 × 640	8960	
AED Plus 8002 153 9D	800	2	3 ~ 400	2738	6.7	32047	2 × 14	8 × 1240	4 × 1240	14880	
AED Plus 8002 204 9D	800	2	3 ~ 400	2738	6.7	30753	2 × 13	10 × 1240	4 × 1240	17360	
AED Plus 8003 230 9D	800	3	3 ~ 400	4107	10.1	48054	2 × 17	8 × 1830	4 × 1830	21960	
AED Plus 8003 306 9D	800	3	3 ~ 400	4107	10.1	46116	2 × 16	10 × 1830	4 × 1830	25620	

EVAPORATORS/ 蒸发器 HFC/HFO(A2L)

AVAILABLE OPTIONS FOR AED SERIES:**Defrost options:**

- Without defrost (air)
- D: Electrical defrost: standard model
- HG: hot gas
- W: water
- HGD: hot gas defrost for coil and electrical defrost for tray
- WD: water and electrical

Tube material options:

- Copper: standard models
- 1: Stainless steel AISI SUS304

Coil protection options:

- Aluminium fins: standard models
- Fins with GOLDFIN anti-corrosion high resistance coating.

Fan options:

- EC Fans

Casing options:

- White powder-coated painted aluminium: standard models
- 2: stainless steel AISI SUS304

Other options:

- Double insulated drip tray (recommended for low temperature room applications)
- Thermal protector for defrosting electrical AEAters

AED 系列选配件:**化霜:**

- 无化霜 (空气)
- D: 电化霜: 标准型号
- HG: 热氟
- W: 水
- HGD: 内芯热氟化霜, 接水盘电化霜
- WD: 水和电化霜

盘管材质:

- 铜管: 标准型号
- 1: 304不锈钢

内芯材质:

- 铝箔: 标准型号
- 高防腐性的金色铝箔

风机:

- EC风机

外壳:

- 铝制白色喷涂: 标准型号
- 2: 304不锈钢

其他:

- 双接水盘 (低温工况推荐)
- 电化霜热保护器

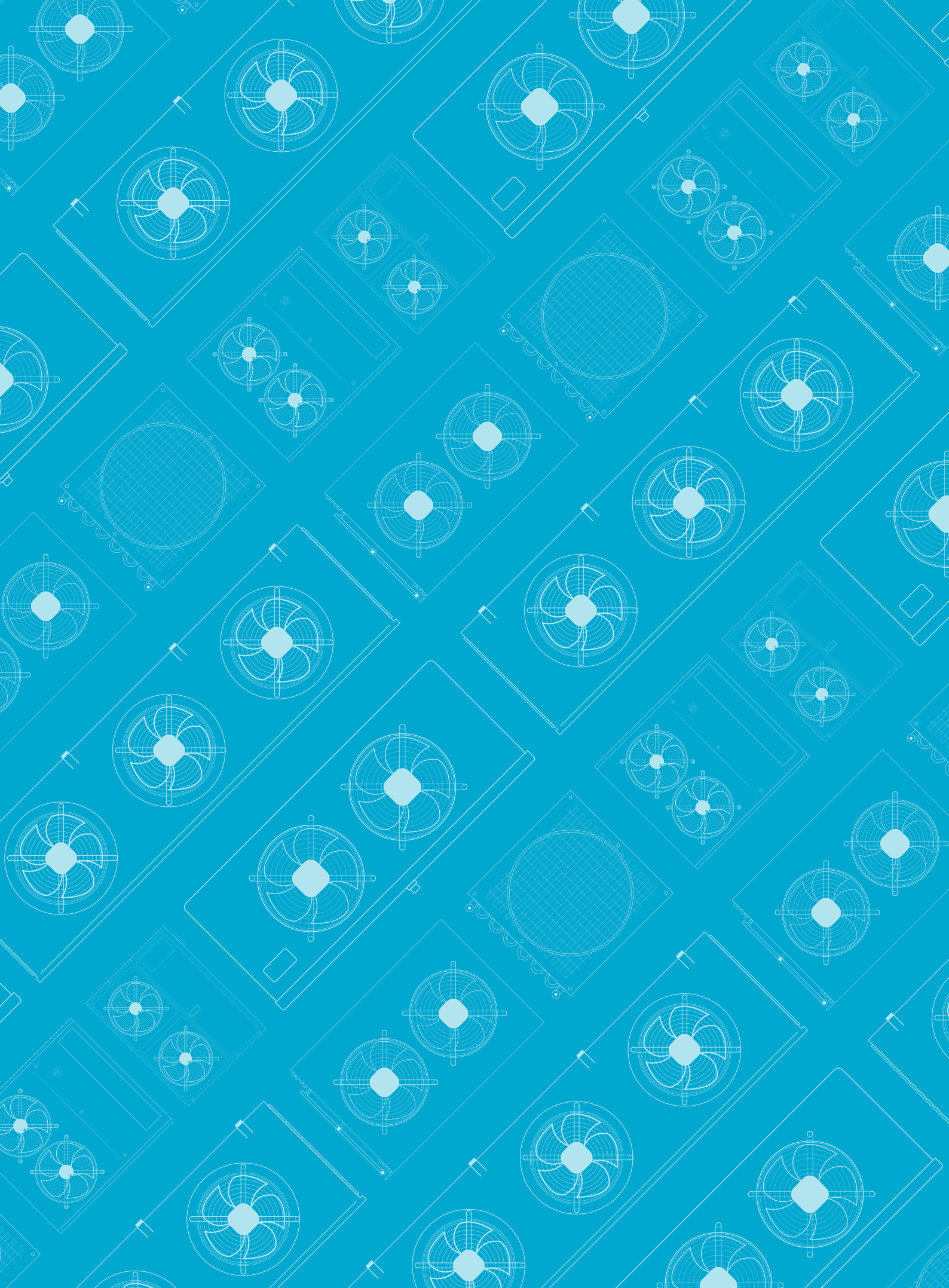



工厂（中国）：

泰州伊士班尼亚制冷设备有限公司

地址：江苏省泰州经济开发区高新技术园标准厂房B区10号

电话：0523-80805003

手机：139-5117-1078; 158-9640-0800; 136-2517-8025; 13222488188

传真：0523-80805666

邮箱：taz39528116@126.com; tzlzw2018@sina.com;

625293588@qq.com; 1367297073@qq.com

网址：<http://www.hispaniacorp.com.cn>;

<http://www.hispaniacorp.com>